



ARCADIA

**Kardinia House**  
1 Riverview Terrace, Belmont

Prepared for Kardinia Gardens  
March 2025



**We respectfully acknowledge the Wadawurrung Traditional Custodians of the lands where we live and work. We acknowledge their unique ability to care for Country and deep spiritual connection to it. We honour Elders past, present and emerging whose knowledge and wisdom has and will ensure the continuation of cultures and traditional practices.**

Rev A	Issued 15 July 2024	Authorised by MY
FINAL A	Issued 22 July 2024	Authorised by MY
FINAL B	Issued 1 November 2024	Authorised by MY
FINAL C	Issued 7 November 2024	Authorised by MY
FINAL D	Issued 21 March 2025	Authorised by NG

Arcadia Geelong  
Level 4/60 Moorabool St, Geelong VIC 3220  
P 03 9491 7310  
E [geelong@arcadiala.com.au](mailto:geelong@arcadiala.com.au)  
[arcadiala.com.au](http://arcadiala.com.au)  
[@arcadialandarch](https://www.instagram.com/arcadialandarch)  
Arcadia Landscape Architecture VIC Pty Ltd  
ABN 62 642 196 469



# Site Context

Kardinia House is situated in the Geelong suburb of Belmont, and is historically significant as one of the oldest residences in the Geelong region.

The original stone house (c. 1850) is still present, though it was extended and renovated in the 1860s and again in the 1880s.

The house has an elevated position within the landscape with views from the house to the Barwon River as well as views of the house from across the River.

- KEY
- 1

BARWON RIVER
- 2

JOHN M MACINTYRE BRIDGE
- 3

BARWON GRANGE
- 4

BARRABOOL RD.
- 5

RIVERVIEW TERRACE
- 6

BARWON VALLEY PARK



1



2



3



5

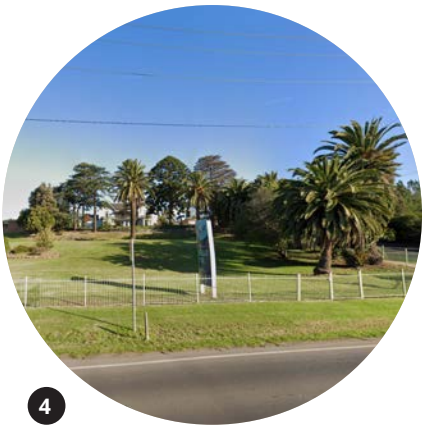

4

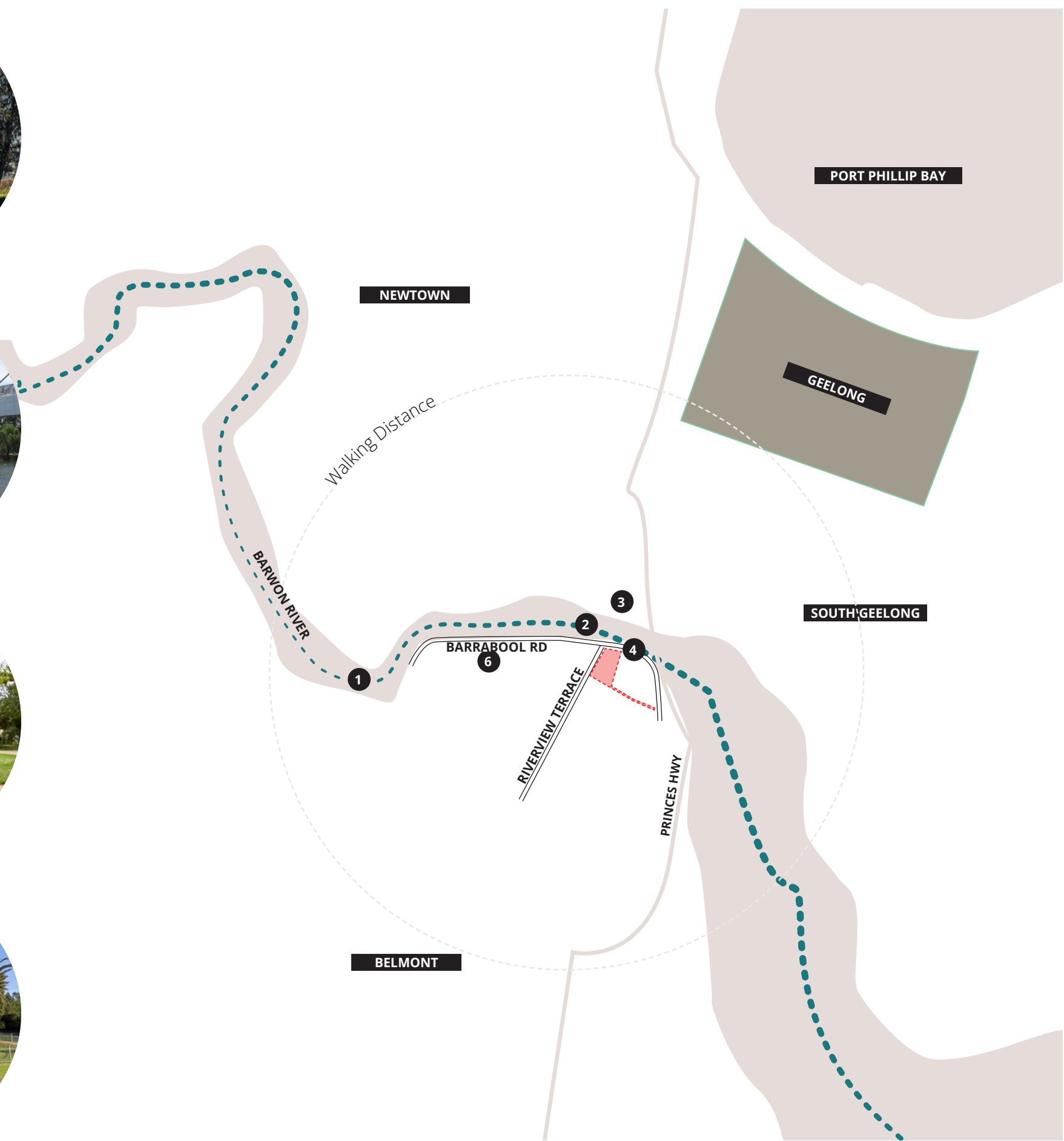



# Riverview Terrace

## Location Plan





# 1 Riverview Terrace

Existing Conditions (Site Photos taken at site visit 09/07/24)



1



5



2



6



3



7

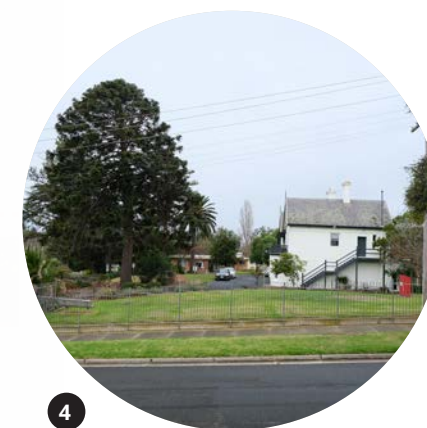

4

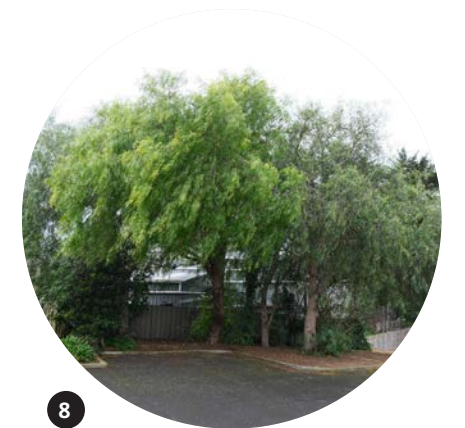

8



# Site History

## Geelong and Barwon River

The location of Kardinia House presents a rich history and opportunity to celebrate both pre and post European cultural heritage.

For the Wadawurrung people, the traditional custodians of the land, the Barwon River provides essential resources and served as a vital trade route, with many sacred sites and stories connected to the landscape.

In the 1850s James Austin, a prominent pastoralist, developed Kardinia House. Kardinia House has served various roles, including as a private residence, a school, and a social venue. The surrounding garden, featuring both Indigenous and exotic plants, present the site's historic character and ecological relevance.



KEY

- 1 *'Aborigines near Geelong'*, 1854, Eugen Von Guerard, From State Library Vic
- 2 *'Aborigines on the road to Ballarat'*, 1854, By Eugene Von Guerard
- 3 *'Kardinia and Flour Mill'*, 1870, Alexander Webb, From Geelong Art Gallery
- 4 *'Aboriginal group near Geelong'*, 1860, author unknown, From State Library Victoria
- 5 *'Barwon river from the bridge'*, 1870, Alexander Webb, From Geelong Art Gallery





# 1 Riverview Terrace

## Demolition Plan

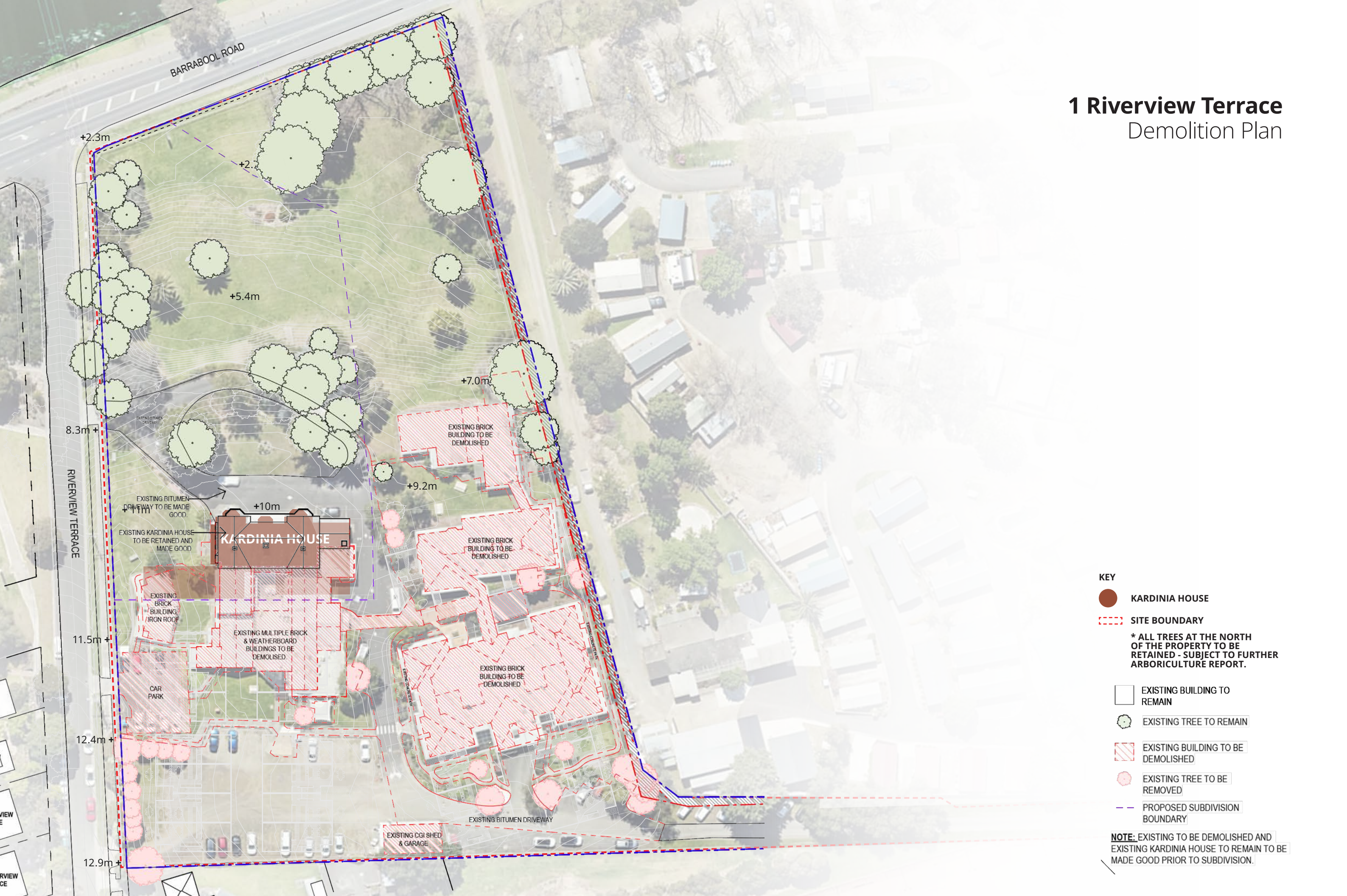



# 1 Riverview Terrace

## Landscape Concept Design



- KEY
- KARDINIA HOUSE
  - SITE BOUNDARY
  - 1 EXISTING LANDSCAPE
  - 2 GARDEN BED
  - 3 RAIN GARDEN
  - 4 TOWN HOUSE MAILBOX
  - 5 BIN ENCLOSURE
  - 6 PRIVATE OPEN SPACE



# 1 Riverview Terrace

## Proposed Fencing Plan





# Town Houses Shared Gardens

## Precedents

The proposed pedestrian lanes and shared gardens are designed to create a lush, immersive landscape to complement the proposed Architecture. They will incorporate a mixture of exotic and native planting and will soften the built form.

### KEY

- 1 PEDESTRIAN LANES
- 2 FEATURE TREE
- 3 SEATING WITHIN CENTRAL GARDEN
- 4 ENTRY STEPPING STONES - ACCESS TO NORTH OF SITE
- 5 SILVER GARDEN PALETTE
- 6 LUSH 'STRAPPY' PLANTING PALETTE
- 7 MAIL BOX DESIGN INTEGRATED WITH ARCHITECTURE





# Park View TH Private Courtyards

## Precedents

The proposed private courtyards are designed to create a lush and formal landscape to complement the proposed Architecture. Incorporating a balance of native and exotic plant species and semi-permeable fencing will enable containment although maintain view of the Barwon River and across Kardinia Gardens.

KEY

- 1 PLANTING AS BOUNDARY: CELEBRATE MATURE TREES AND 'KARDINIA' (MORNING/ SUNSET)
- 2 NATIVE PLANTING WITH POST-EUROPEAN STYLE
- 3 PROVIDE AMENITY IN A GREEN CONTEXT
- 4 LAYERED PLANTING FOR PRIVACY
- 5 LUSH COURTYARDS THAT SOFTEN THE BUILDING EDGES





# Garden View and Belmont View TH Private Courtyards

## Precedents

The proposed private courtyards are designed to create a lush and formal landscape to complement the proposed Architecture. Incorporating a balance of native and exotic plant species with semi-permeable fencing.

### KEY

- 1 DECIDUOUS FEATURE TREE
- 2 RETAINING WALL
- 3 NATIVE PLANTING WITH POST-EUROPEAN STYLE
- 4 LAYERED HEDGE ALONG PALING FENCE
- 5 ENTRY STEPPING STONES WITHIN GREENERY
- 6 SEMI-PERMEABLE FENCE, PLANTING AS LIMIT
- 7 LUSH PLANTING PALETTE
- 8 FUNCTIONAL PAVED AREA

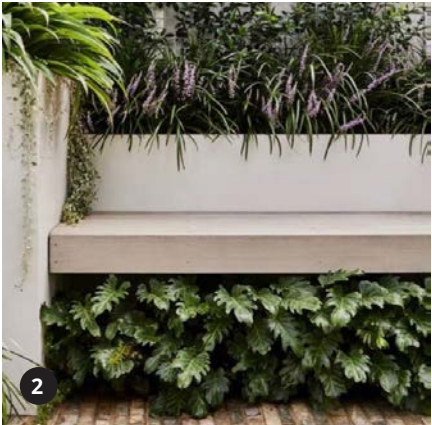



Preliminary Planting Palette

TREES & PALMS



*Bursaria spinosa*



*Dicksonia antarctica*



*Laurus nobilis* 'Miles Choice'



*Magnolia grandiflora* 'Little Gem'



*Hakea laurina*

GRASSES & RUSHES



*Themeda triandra*



*Lomandra* 'Tanika'



*Dianella longifolia*



*Rytidosperma penicillatum*



*Anigozanthos hybrida* 'Bush Ballad'

SHRUBS & ACCENTS



*Westringia* 'Mundi'



*Adenanthos sericeus*



*Alpinia caerulea*



*Arthropodium cirratum*



*Asparagus densiflorus* 'Meyersii'



*Asplenium nidus*



*Banksia spinulosa*



*Correa alba*



*Strelitzia reginae*



*Ligularia reniformis*



*Microseris lanceolata*



*Olearia pimeleoides*



*Philodendron* 'Xanadu'



*Phormium tenax* 'Dark Delight'



*Pittosporum tobira* 'Miss Muffet'



*Prostanthera rotundifolia*



*Pultenaea gunnii*



*Westringia fruticosa* 'Jervis Gem'



*Acacia* 'Mini Cog'

GROUNDCOVERS & CLIMBERS



*Casuarina glauca* 'Cousin It'



*Chenopodium nutans*



*Chrysocephalum semipapposum*



*Clematis aristata*



*Dichondra repens*



*Dichondra* 'Emerald Falls'



*Dichondra* 'Silver Falls'



*Einadia nutans*



*Goodenia ovata*



*Hardenbergia violacea* 'Happy Wanderer'



*Myoporum parvifolium*



*Rosmarinus officinalis* 'Prostrata'



*Scaevola calendulacea*



*Senecio serpens*



*Veronica perfoliata*



*Viola hederacea*

13 1 Riverview Terrace | Kardinia House | Project No. M24-102

ARCADIA



A blurred background of a park with people walking on a path, overlaid with the word 'ARCADIA' in white text.

ARCADIA