

01 JOCKEYS' CONVALESCENT LODGE - DEMOLITION PLAN
1:100

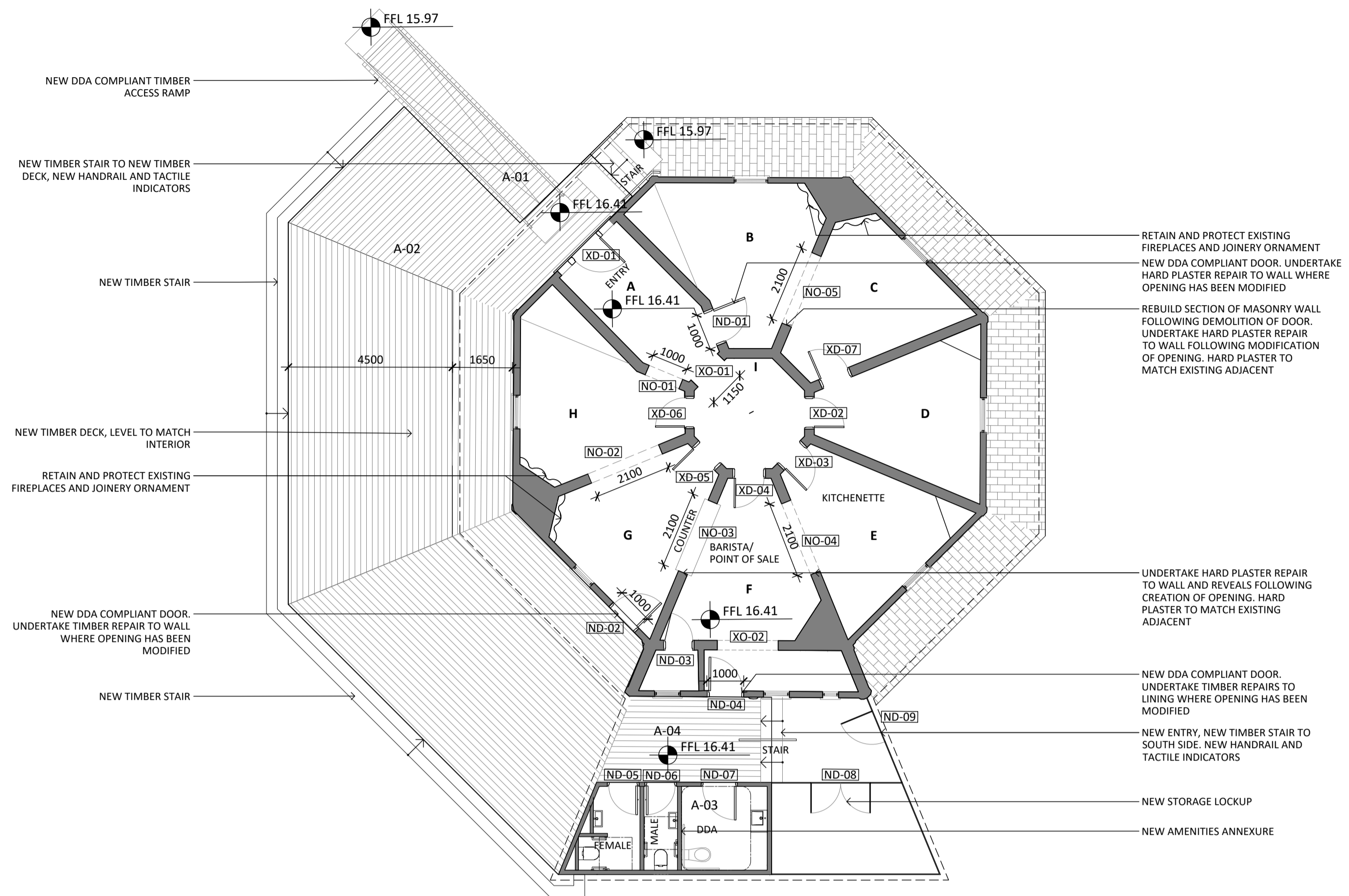

02 JOCKEY'S CONVALESCENT LODGE - PROPOSED PLAN
1:100



03 JOCKEYS' CONVALESCENT LODGE - SITE PLAN
1:1000

GENERAL NOTES:

- ALL DRAWINGS ARE TO BE READ IN CONJUNCTION WITH THE ARCHITECTURAL SPECIFICATION AND SCHEDULES OF WORKS.
- ALL DRAWINGS ARE TO BE READ IN CONJUNCTION WITH ALL CONSULTANT DOCUMENTATION.
- ALL EXISTING FABRIC TO BE RETAINED IS TO BE PROTECTED FROM UNWANTED DAMAGE WHERE POSSIBLE DEMOLISHED FABRIC IS TO BE SALVAGED FOR RECYCLING

ROOM LEGEND:

- A ENTRY
- B DINING/EAT IN
- C DINING/EAT IN
- D DINING/EAT IN
- E KITCHENETTE
- F BARISTA/POINT OF SALE
- G DINING/ORDERING TAKEAWAY
- H DINING/EAT IN
- I WALL DEDICATED TO HISTORY
- J TOILETTES
- K STORAGE AND WASTE

SCOPE OF PROPOSED ALTERATIONS:

- A-01 NEW DDA COMPLIANT ACCESS RAMP AND STAIR
- A-02 NEW DECK, LEVEL TO MATCH INTERNAL
- A-03 NEW AMENITIES
- A-04 DEMOLITION AND ALTERATION TO SOUTH ENTRY

NEW OPENINGS:

- NO-01 NEW DDA COMPLIANT OPENING TO DECK
- NO-02 NEW DDA COMPLIANT OPENING BETWEEN DINING & BARISTA/POINT OF SALE AREA
- NO-03 NEW OPENING BETWEEN KITCHENETTE & BARISTA AREA
- NO-04 EXISTING DOOR TURNED INTO NEW WIDE OPENING.

NEW DOORS:

- ND-01 NEW DDA COMPLIANT DOOR TO DDA TOILET AND OFFICE AREA THROUGH DINING ROOMS
- ND-02 NEW DDA ACCESS FROM DINING TO DECK
- ND-03 NEW DOOR TO PANTRY
- ND-04 NEW DOOR TO BACK OF HOUSE/SERVERY
- ND-05 NEW DOOR TO FEMALE TOILET
- ND-06 NEW DOOR TO FEMALE TOILET
- ND-07 NEW DOOR TO DDA TOILET
- ND-08 NEW GATE TO STORAGE
- ND-09 NEW GATE TO ENCLOSURE

EXISTING OPENING:

- XO-01 TO BE RETAINED

EXISTING DOORS:

- XD-01 TO BE RETAINED
- XD-02 TO BE RETAINED
- XD-03 TO BE RETAINED
- XD-04 TO BE RETAINED
- XD-05 TO BE RETAINED
- XD-06 TO BE RETAINED
- XD-07 TO BE RETAINED

EXISTING WINDOWS:

ALL TO BE RETAINED

NET AREA:

EXISTING BUILDING	112sqm
OPEN DECK	145sqm
DECK CIRCULATION	27sqm
AMENITIES/ADDITION	24sqm

LEGEND:

- DEMOLITION

NOT FOR CONSTRUCTION

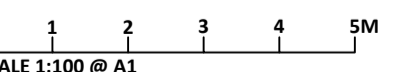

NO.	DATE	REVISION
HV1	08/12/2023	HERITAGE VICTORIA

NOTE: ALL DIMENSIONS ARE TO BE VERIFIED ON SITE BEFORE COMMENCING ANY WORK OR PREPARING ANY SHOP DRAWINGS. SCALE INDICATED FOR REFERENCE ONLY. DO NOT SCALE OFF DRAWINGS. DO NOT SCALE DRAWINGS. OMISSIONS OR DISCREPANCIES ARE TO BE NOTIFIED TO THE ARCHITECT.

COPYRIGHT: THIS DRAWING IS COPYRIGHT AND REMAINS THE PROPERTY OF LOVELL CHEN.

PACE DEVELOPMENT
2/201 FITZROY ST, ST KILDA, VIC 3182

LOVELL CHEN
LEVEL 5, 176 WELLINGTON PARADE
EAST MELBOURNE 3002 AUSTRALIA
TEL +61 (0)3 9667 0800
enquiry@lovellichen.com.au
www.lovellichen.com.au

PROJECT
550 EPSOM ROAD,
FLEMINGTON RACECOURSE

LOCATED ON WURUNDJERI COUNTRY
DRAWN JT CHECKED MT PROJECT NO. 8832 DATE NOVEMBER 2023

DRAWING TITLE
JOCKEYS' CONVALESCENT LODGE
EXISTING AND PROPOSED PLAN

PREPARED ON THE LANDS OF THE WURUNDJERI PEOPLE
ISSUE AUTHORITY SCALE 1:100@A1 DRAWING NO. HA-01 REVISION HV1

