



Landscape Masterplan - DRAFT

Thomson Water Gardens, Footscray Park
Footscray

1:250 @ A1

Legend

- Existing trees to be retained
- Existing playground fence
- Lawn area
- Existing garden bed
- Existing water body (<500mm Deep)
- Existing water body (>500mm Deep)
- + (IL 1.74M) Existing water depth

Proposed measures

- Refer page 2 for details
- Existing garden bed. Changes include:
- Infill planting
- Irrigation system
 - Areas of garden bed expansion (Where existing garden bed <1m wide)
 - Fence type 1 - Reo hoop garden edge
 - Fence type 2 - Timber batten fence
 - Maintenance gate (to match fence type 2)
 - Water aeration device

- Rock benching
- Hazard and Instructional signage
- Depth marker sigange
- Existing furniture to be rotated
- Existing platypus fountain to be restored and made operational
- Proposed asphalt pavement with bluestone pither edge.
- Proposed sub surface electrical supply to power aeration device and irrigation system

Note
1) Where existng vegetation obscures visibility of water body, pruning and or removal of vegetation may be required.

Infill garden bed planting

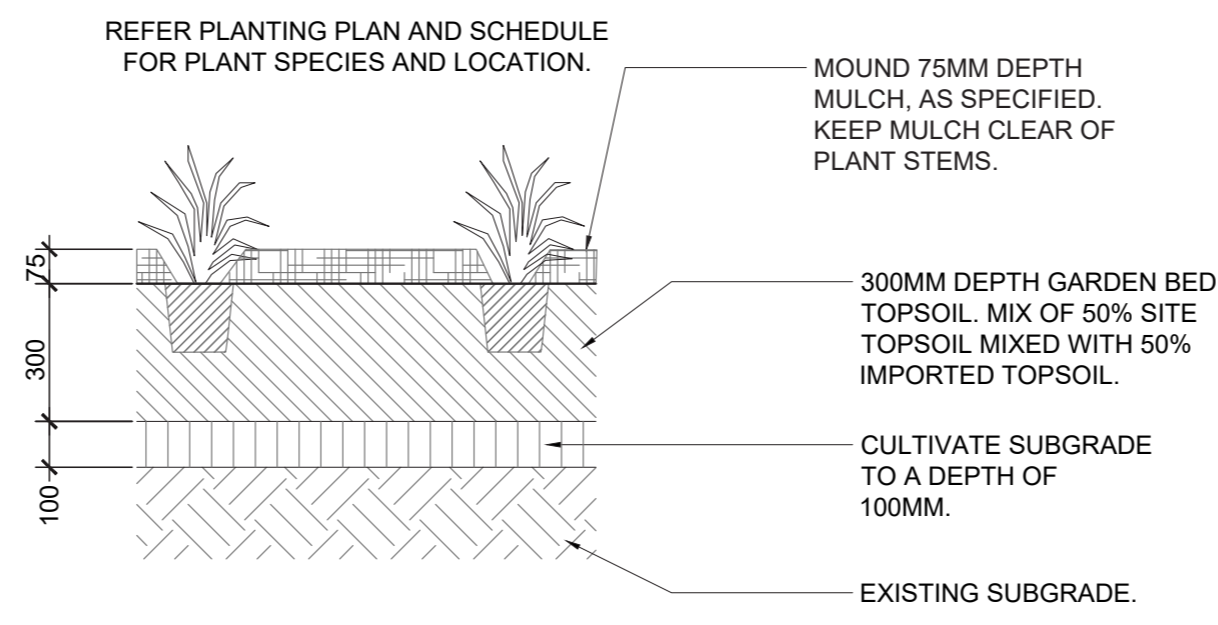

Garden Bed planting Detail

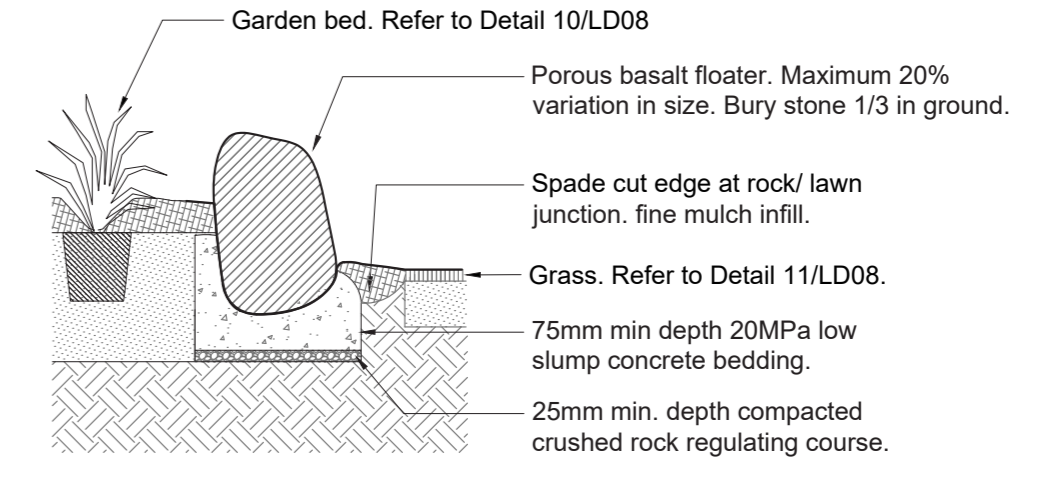

Garden Bed Edge Detail



Chryscephalum apiculatum



Stachys Byzantina



Kniphofia



Aloe maculata



Senecio serpens



Clivia miniata



Agave attenuata



Carpobrotus rossii



Agave stricta



Corydalis orbicula



Dietes grandiflora



Lomandra 'Little Con'

Fence type 1 - reo hoop fence

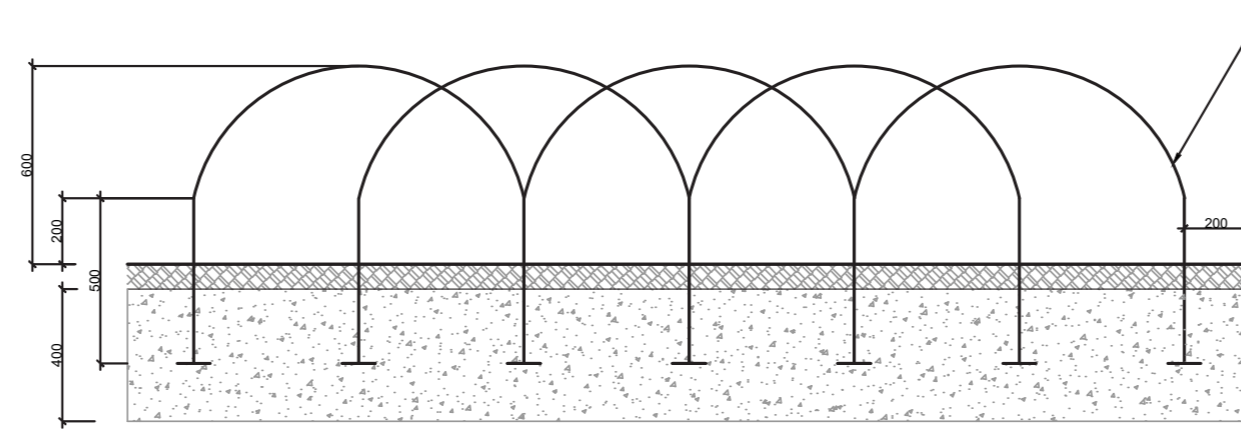

7 TYP. F1 - RE-BAR FENCING DETAIL

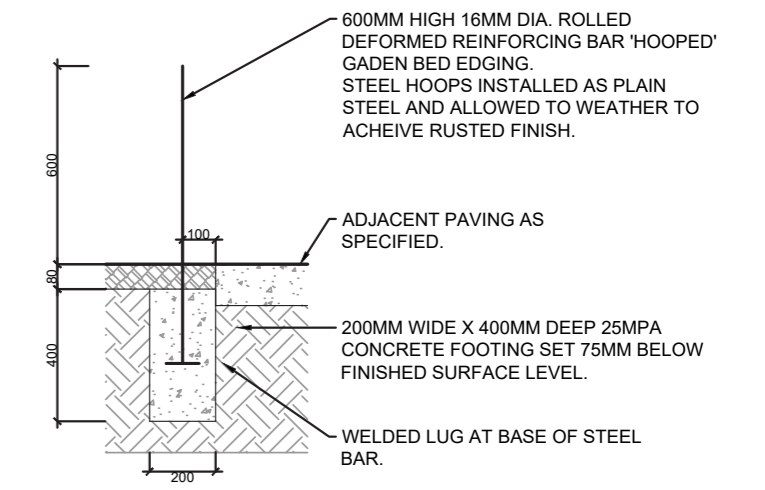

**Fence type 2 & Maintenance access gate
Hardwood batten fence**

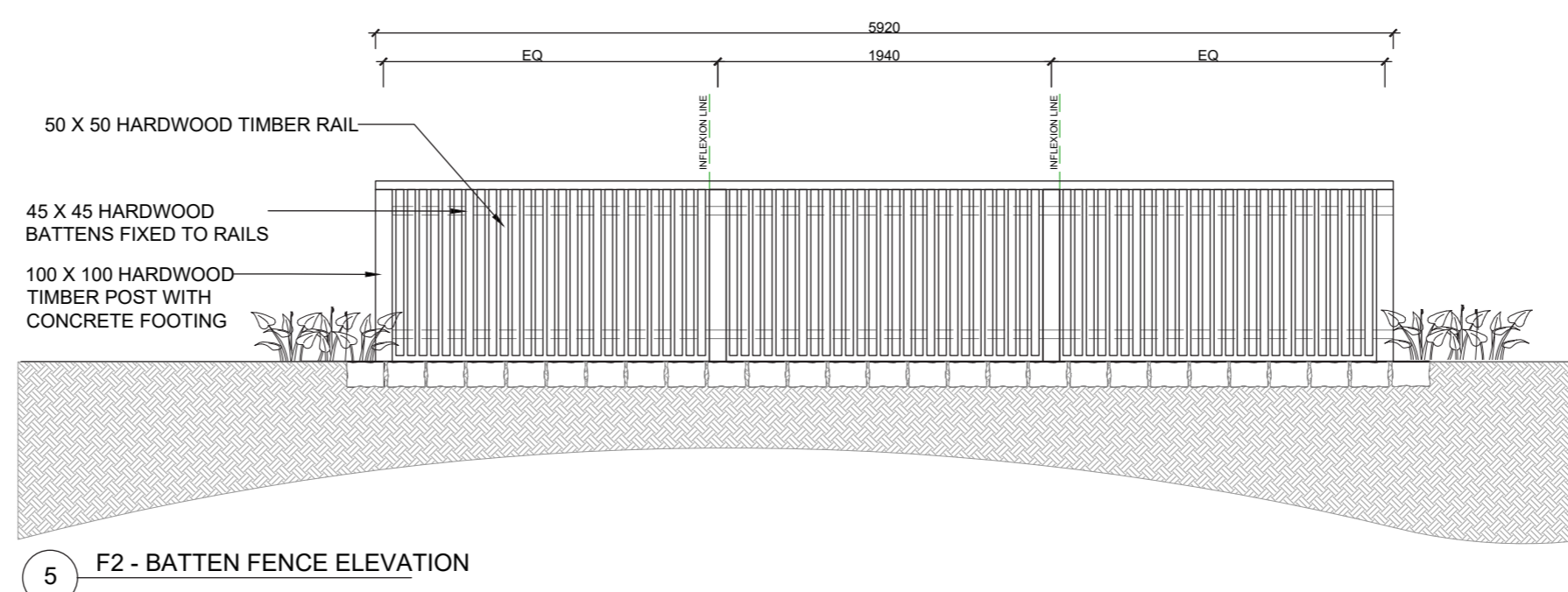

5 F2 - BATTEN FENCE ELEVATION

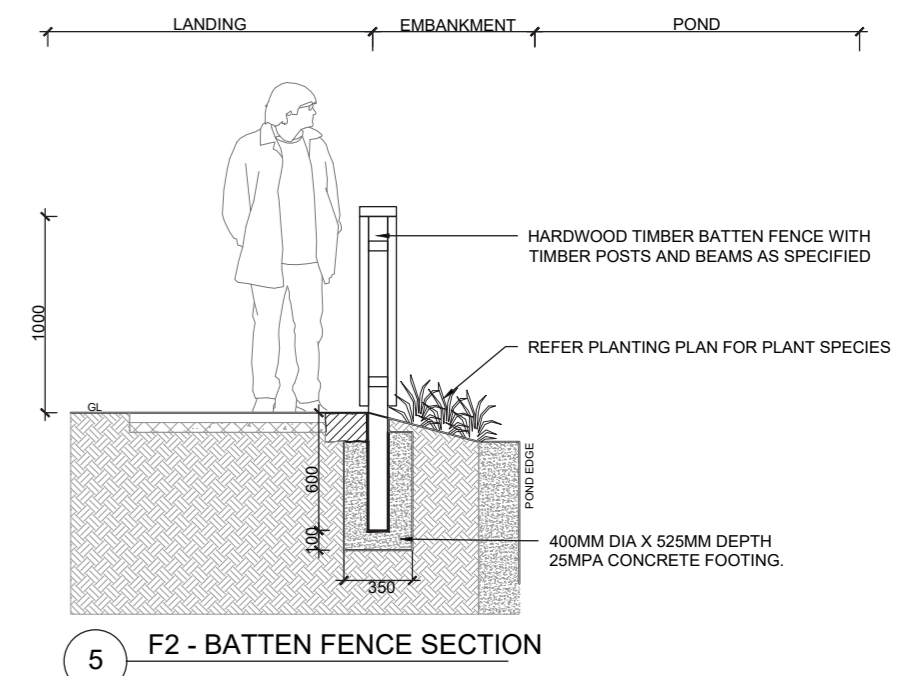

5 F2 - BATTEN FENCE SECTION

Asphalt pavement with bluestone edge

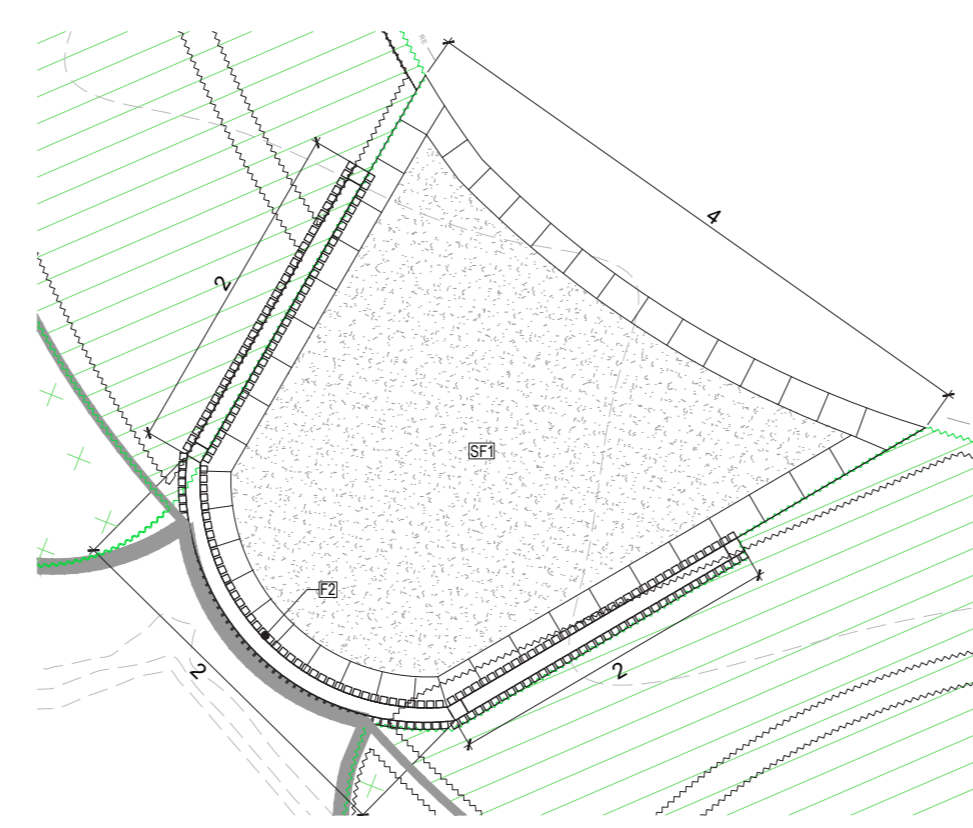

6 LANDING SETOUT PLAN

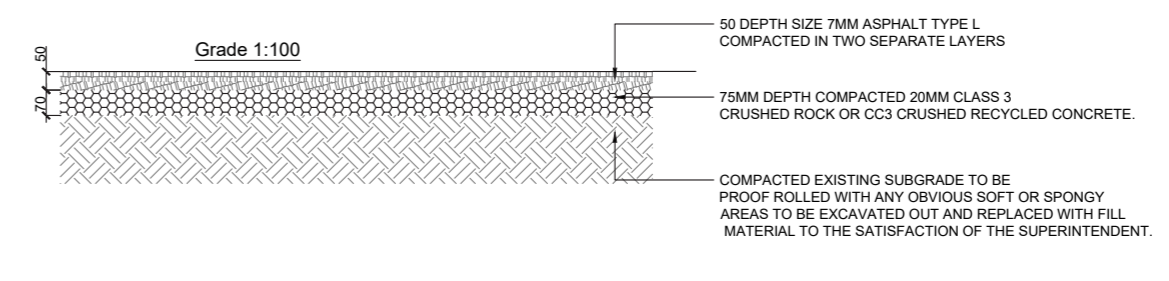

4 TYP. SF1 ASPHALT PAVEMENT DETAIL

Rock benching

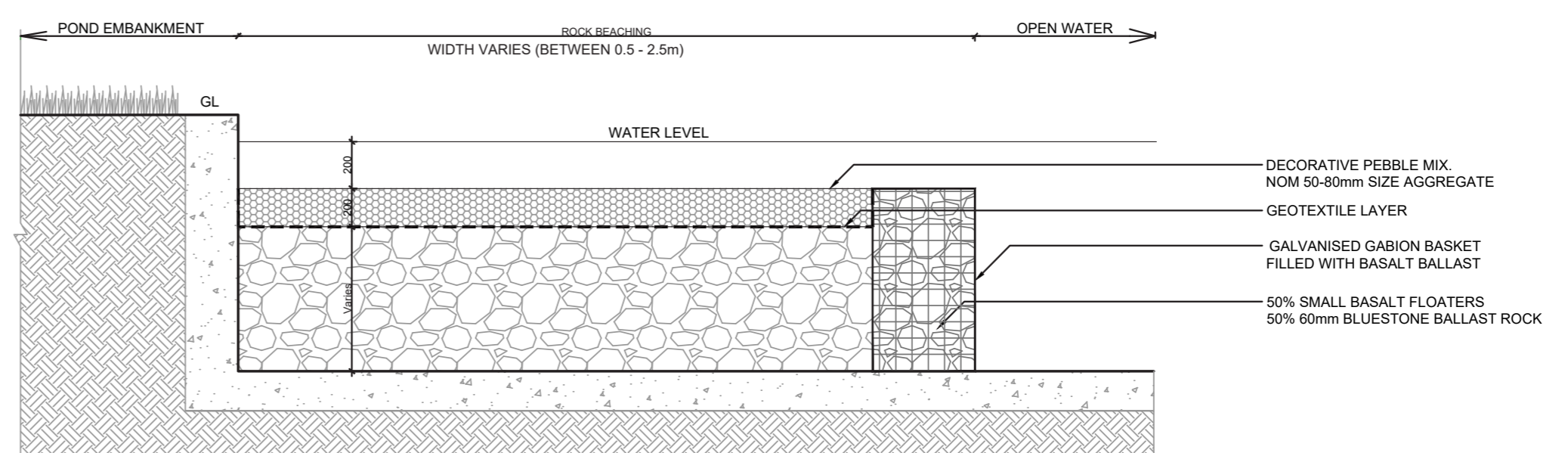

Warning and directional signage
Product TBC by Surf Lifesaving Victoria



Aeration device
Product: Aquatic technologies Evolution 1/2 HP Aeration Fountain or similar approved
Tethered to fixings on pond perimeter

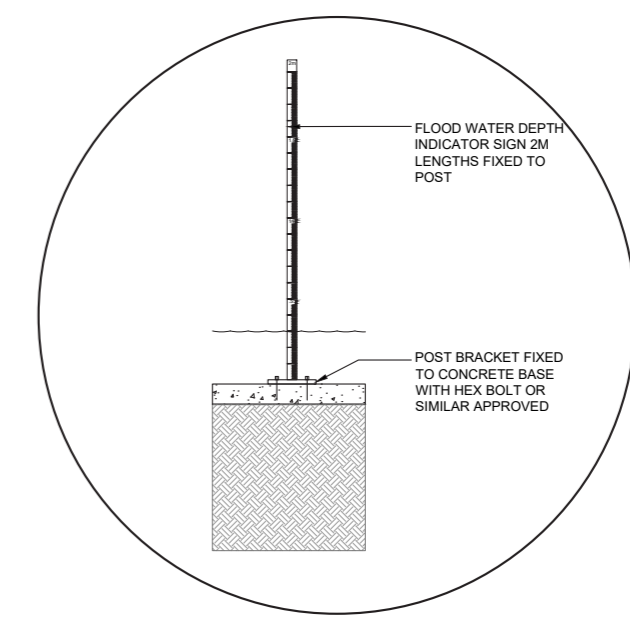

Depth marker
Product TBC
Bolt fixed to pond base



Plant palette

VE1 - Terrestrial Plant Species	
Botanical name	Common name
Shaded garden beds (Irrigated)	
<i>Acanthus Mollis</i>	Oyster plant
<i>Ajuga Repetans</i>	Bugle
<i>Alocasia macrorhiza</i>	Elephant ear plant
<i>Aralia japonica</i>	Japanese aralia
<i>Arthropodium cirratum 'Matapouri Bay'</i>	Renga Renga Lilly
<i>Aspidistra Elatior</i>	Cast iron plant
<i>Asplenium Spp</i>	Spleenwort
<i>Aucuba japonica</i>	Spotted laurel
<i>Bergenia cordifolia</i>	Elephant ear
<i>Clivia miniata</i>	Clivia
<i>Cordylone terminalis</i>	
<i>Dianella Cassa Blue DBB03</i>	Dianella
<i>Dichondra repens</i>	Kidney Weed
<i>Dichondra repens 'Silver Falls'</i>	Silver Nickel Vine
<i>Dietes grandiflora</i>	Large Wild Iris
<i>Fuchsia sp.</i>	
<i>Hamamelis Mollis</i>	Witch hazel
<i>Hedychium gardnerianum</i>	Ginger lilly
<i>Helleborus orientalis</i>	Lenten rose
<i>Hippeastrum puniceum</i>	Barbaods lilly
<i>Homalanthus populifolius</i>	Native Bleeding heart
<i>Hydrangea macrophylla</i>	Hydrangea
<i>Hypericum calycinum</i>	Aarons beard
<i>Impatiens oliveri</i>	Impatiens
<i>Iris unguicularis</i>	Iris
<i>Jacobinea carnea</i>	Brazilian plume flower
<i>Lantana montevidensis</i>	Trailing lantana
<i>Liriope muscari</i>	Turf lilly
<i>Ivivostona australis</i>	Cabbage tree palm
<i>Mackaya bella</i>	Forest bell bush
<i>Mahonia aquifolium</i>	Oregon Grape
<i>Monstera deliciosa</i>	Swiss cheese plant
<i>Nandina domestica</i>	Heavenly bamboo
<i>Osmanthus aquifolium</i>	Holly olive
<i>Pelargonium peltatum</i>	Geranium
Philodendron Xanadu	
<i>Philodendron Xanadu</i>	Xanadu
<i>Polypodium Spp</i>	Caterpillar fern
<i>Roidana petasites</i>	velvet groundsel
<i>Ruscus aculeatus</i>	Burchers broom
<i>Salvia heat wave blaze</i>	Sage
<i>Sambucus niger</i>	Black elderberry
<i>Scilla non scripta</i>	English blue bells
<i>Strobilanthes gossypinus</i>	Persian Shield
<i>Tetrapanax papyriferus</i>	Rice paper plant
<i>Trachycarpus fortunei</i>	The hardy palm
<i>Zantedeschia Sp.</i>	Peace lily
Botanical name	
Common name	
Shaded garden beds (non-irrigated)	
<i>Agapanthus</i>	Agapanthus
<i>Crassula multicaeva</i>	Fairy crassula
<i>Dietes grandiflora</i>	Dietes
<i>Euphorbia robbiae</i>	Mrs Robb's Bonnet
<i>Lamium scandens</i>	
Botanical name	
Common name	
Part sun + irrigated	
<i>Choisya ternata</i>	Mexican orange blossom
<i>Doryanthes palmeri</i>	Spear lily
<i>Eucomis comosa</i>	pineapple flower
<i>Gardenia Thunbergii</i>	tree gardenia
<i>Keria japonica</i>	japanese rose
<i>Leucojum vernum</i>	Spring snowflake
<i>Loropetalum Chinese</i>	Chinese fringe flower
<i>Nandina domestica</i>	Heavenly bamboo
<i>Ribes sanguineum</i>	Flowering currant
<i>Tibouchina urvilleana</i>	Princess flower
<i>Viburnum suspensum</i>	Viburnum
Botanical name	
Common name	
Full sun	
<i>Abelia grandiflora</i>	Glossy abelia
<i>Achillea millefolium - 'Cerise Queen'</i>	Cerise Queen
<i>Agapanthus Spp.</i>	Agapanthus
<i>Agastache aurantiaca</i>	Humming Bird mint
<i>Agave attenuata</i>	Swan Neck Agave
<i>Agave attenuata 'Blue flame'</i>	Agave Blue Flame
<i>Agave multiflora</i>	Shaggy Head Agave
<i>Agave Striata</i>	Needle leaf agave

<i>Agave stricta</i>	Hedgehog Agave
<i>Aloe maculata</i>	Spotted Aloe
<i>Alstroemeria Sp</i>	Peruvian lily
<i>Amaryllis balladonia</i>	Belladonna lily
<i>Arctotis xhybrida</i>	African Daisy
<i>Artemisia alba canescens</i>	Powis Castle
<i>Asarum canadense</i>	Canada Wild Ginger
<i>Ballota pseudodictamnus 'Nana'</i>	The False dittany
<i>Buddleja</i>	Buddleja
<i>Buxus sempervirens</i>	Box hedge
<i>Calamagrostis x acutiflora 'Karl Foerster'</i>	Feather Reed Grass
<i>canna indica</i>	Indian shot
<i>Carpobrotus Rossii</i>	Pig Face
<i>Ceratostigma willmottianum</i>	Chinese plumbago
<i>Chaenomeles japonica</i>	Japanese quince
<i>Chrysocephalum apiculatum</i>	Common Everlasting
<i>Cistus purpureus</i>	Orchid Rockrose
<i>Coleonema album</i>	White diosma
<i>Cordylone australis</i>	Cabbage tree
<i>Cotyledon orbiculata</i>	Cotyledon
<i>Dianella Cassa Blue DBB03</i>	N/A
<i>Dietes grandiflora</i>	Large Wild Iris
<i>Echium pinninatum</i>	Tower of Jewels
<i>Echium fastuosum</i>	Pride of Madiera
<i>Eleagnus pungens 'Aurea'</i>	Maculata aurea
<i>Euonymus japonicus</i>	Japanese spindle
<i>Euphorbia characias</i>	Mediterranean spurge
<i>Gaillardia xgrandiflora 'Fanfare'</i>	Blanket Flower
<i>Gardenia thunbergii</i>	Gardenia
<i>Gazania</i>	Gazania
<i>Gazania rigens var. leucoleana</i>	Gazania
<i>Hebe speciosa</i>	Old Hebe
<i>Helichrysum italicum subsp. Serotinum</i>	Curry plant
<i>Helichrysum PETIOLARE</i>	Licorice plant
<i>Hemerocallis 'stella dora'</i>	Daylily
<i>Hibiscus rosa sinesis</i>	Hibiscus
<i>Hymenocallis americana</i>	Spider lily
<i>Iris germanica</i>	Bearded iris
<i>Iris orientalis</i>	Iris
<i>Iris unguicularis</i>	iris
<i>Juniperus sabina</i>	Savin juniper
<i>Knifofia uvaria 'Winter Cheer'</i>	Red hot poker
<i>Knifofia 'James Nottle'</i>	Knifophia
<i>Lachenalia tricolor</i>	Soldier boys
<i>Lavender Dentata</i>	French Lavender
<i>Ligustrum ovalifolium 'Aureum'</i>	Golden privet
<i>Limonium perezii</i>	Perennial Statice
<i>Lomandra confertifolia 'Little Con'</i>	Small Mat-rush
<i>Lomandra tanika</i>	mat rush
<i>malva viscus arboreus</i>	Texas mallow
<i>melianthus major</i>	Honey bush
<i>Mesembryanthemum cordifolium</i>	Baby sun rose
<i>Myoporum parvifolium</i>	Creeping Boobialla
<i>Ophiopogon Japonicus Nanus</i>	Mondo Grass
<i>Ornithogalum umbellatum</i>	Grass lily
<i>Phormium tenax</i>	New Zealand flax
<i>Phymosia umbellata</i>	Mexican bush mallow
<i>Plumbago auriculata</i>	Cape leadwort
<i>Polygonum capitatum</i>	Pink knotweed
<i>Prunus glandulosa</i>	Dwarf flowering almond
<i>Raphiolepis indica</i>	Indian Hawthorn
<i>Rosa Spp.</i>	Flower Carpet 'Pink
<i>Royena lucida</i>	African snow drop
<i>Rudbeckia 'goldsturm'</i>	Black eyed susan
<i>Salvia 'Marine Blue'</i>	Salvia Marine Blue
<i>Salvia azurea</i>	blue sage
<i>Salvia uliginosa</i>	bog sage
<i>Santolina chamaecyparissus</i>	Lavender Cotton
<i>Sedum</i>	Fire cracker
<i>Sedum acre</i>	Wall Pepper
<i>Senecio Serpens (Curio talinoides var. mandraliscae)</i>	Blue Chalk Sticks
<i>Stachys byzantina</i>	Lambs Ear
<i>Strelitzia reginae</i>	Birds of paradise
<i>Syringa vulgaris</i>	common lilac
<i>Thymus serpyllum coccineus</i>	Red Creeping Thyme
<i>Tradescantia pallida 'Purpurea'</i>	Purple heart
<i>Tulbaghia Dark Star</i>	Dark Star
<i>Tulbaghia violacea</i>	Society Garlic
<i>Agave americana</i>	Century plant
<i>Aloe arborescens</i>	Octopus plant
<i>Cotyledon sp.</i>	Cotyledon
<i>Crassula multicaeva</i>	London pride

VE2 - Aquatic Plant Species	
Ephemeral Species (NWL - 350mm above NWL)	
<i>Cyperus lucidus</i>	Leafy flat sedge
<i>Juncus pallidus</i>	Pale Rush
<i>Juncus flavidus</i>	Yellow Rush
Shallow Marsh Species (100 - 150mm below NWL)	
<i>Bolboschoenus medianus</i>	Marsh Club-rush
<i>Cladium procerum</i>	Leafy Twig-rush
<i>Cyanogeton procerum (syn. Triglochin procerum)</i>	Water Ribbons
Deep Marsh Species (150-300mm below NWL)	
<i>Baumea articulata</i>	Jointed Club-rush
<i>Bolboschoenus medianus</i>	Marsh Club-rush
<i>Bolboschoenus caldwellii</i>	Sea Club-rush
<i>Cyanogeton procerum (syn. Triglochin procerum)</i>	Water Ribbons
Submerged Marsh Species (300-700mm below NWL)	
<i>Myriophyllum crispatum</i>	Upright Water-milfoil
Aquatic Mix Planting	
Mix 1 (Ephemeral Mix)	
<i>Cyperus lucidus</i>	Leafy flat sedge
<i>Juncus pallidus</i>	Pale Rush
Mix 2 (Shallow marsh mix)	
<i>Bolboschoenus medianus</i>	Marsh Club-rush
<i>Cladium procerum</i>	Leafy Twig-rush
<i>Juncus flavidus</i>	Water Ribbons
Mix 3 (Deep Marsh mix)	
<i>Baumea articulata</i>	Jointed Club-rush
<i>Bolboschoenus medianus</i>	Marsh Club-rush
<i>Bolboschoenus caldwellii</i>	Sea Club-rush
<i>Cyanogeton procerum (syn. Triglochin procerum)</i>	Water Ribbons