

Landscape Documentation Package

BALAK KALIK MANYA WALKING TOGETHER - Kalimna Park

CLIENT CONTACT:
Djandak | Dja Dja Wurrung Clans
Aboriginal Corporation

Harley Douglas
Project Manager
e: harley.douglas@djadjawurrung.com.au
p: 03 5444 2888
m: 0428 046 798

PROJECT ADDRESS:

Kalimna Point
Castlemaine Diggings
National Heritage Park
Castlemaine, 3450

CONSULTANT CONTACT:
Pollen Studio P/L

Flynn Hart
Director / Registered Landscape Architect
e: flynn@pollenstudio.com.au
p: 03 9329 7548
m: 0418 566 939

Bede Brennan
Senior Landscape Architect
e: bede@pollenstudio.com.au
p: 03 9329 7548
m: 0402 431 403

ACKNOWLEDGEMENT OF COUNTRY:

We acknowledge and respect Traditional Owners as the original custodians of Victoria's land and waters that were never ceded. We honour elders past and present whose knowledge, connection and wisdom has ensured the continuation of culture and care for Country for tens of thousands of years.

PROJECT PHASE:

Detailed Concept Plans for Documentation

DRAFT

Issue: 2 15.09.2021

LOCATION PLAN:



DRAWING REGISTER:

DRAWING NO.	DRAWING TITLE	SHEET	REV.
LDD-000	Cover Page	1	B
LDD-100	Performance Notes	2	B
LDD-101	Context Plan	3	B
LDD-200	Existing Conditions & Demolition	3	B
LDD-201	Existing Conditions & Demolition	3	B
LDD-202	Existing Conditions & Demolition	4	B
LDD-300	Set Out	5	B
LDD-301	Set Out	6	B
LDD-302	Set Out	7	B
LDD-400	Surfaces, Finishes, Furniture & Levels	8	B
LDD-401	Surfaces, Finishes, Furniture & Levels	9	B
LDD-402	Surfaces, Finishes, Furniture & Levels	10	B
LDD-500	Planting Plan & Schedule	11	B
LDD-501	Planting Plan & Schedule	12	B
LDD-502	Planting Plan & Schedule	13	B
LDD-503	Planting Plan & Schedule	14	B

POLLEN

Pollen Studio Pty Ltd - Landscape Architects
BRUNSWICK - Siteworks
Studio 1 | Level 1 | 33 Saxon Street VIC 3056
03 9329 7548 | pollen@pollenstudio.com.au
pollenstudio.com.au | ABN 45 494 020 124

PROJECT
BALAK KALIK MANYA WALKING
TOGETHER - Kalimna Park
Landscape Works
CLIENT
Djandak | Dja Dja Wurrung Clans
Aboriginal Corporation

CLIENT REFERENCE
-
JOB NUMBER
201102

PHASE
**Detailed Concept Plans
for Documentation**
DRAFT
DRAWING TITLE
Cover Page

REV.	COMMENT	DATE
A	DRAFT DETAILED CONCEPT FOR REVIEW	02.08.21
B	FOR CONSTRUCTION	15.09.21

DRAWN **BB** CHECK **FH**

SCALE
1:1000 @A1 1:2000 @A3
SHEET
1 of 14
DRAWING NO.
LDD-000

NORTH

ISSUE
2

PERFORMANCE NOTES

COUNTRY PLAN

THESE WORKS ARE INTENDED TO ALIGN WITH THE DJA DJA WURRUNG COUNTRY PLAN (2014-2034). THESE DRAWINGS HAVE BEEN DEVELOPED IN COLLABORATION WITH DJANDAK WITH AN UNDERSTANDING OF THE GOALS IN THE COUNTRY PLAN. IN PARTICULAR: GOAL 4: BUSHTUCKER AND MEDICINE GOAL 5: RIVERS AND WATERWAYS GOAL 6: HEALING UPSIDE-DOWN COUNTRY.

THE SPECIFIC MANAGEMENT PLAN FOR THE SITE, ALSO DEVELOPED BY DJANDAK, INFORMS THIS DESIGN AND IS RELEVANT TO ITS IMPLEMENTATION.

GENERAL REQUIREMENTS

THE WORKS OF THIS TENDER SHALL COMPRISE THE SUPPLY OF ALL MATERIALS AND COMPLETION OF CONSTRUCTION WORKS ASSOCIATED, AS SHOWN ON THE ACCOMPANYING DRAWINGS AND DESCRIBED WITHIN THE FOLLOWING PERFORMANCE NOTES.

CONTRACTOR IS TO COMPLY WITH WORKING HOURS STIPULATED IN THE LOCAL COUNCIL'S ORDINANCES AND EPA NOISE OMISSION GUIDELINES. ALL BUILDING WORKS ARE TO BE COMPLETED IN ACCORDANCE WITH THE BUILDING ACT 1993, BUILDING REGULATIONS 2006 & RELEVANT BUILDING CODE OF AUSTRALIA 2016.

ROLES & RESPONSIBILITIES

PROJECT SUPERVISOR

THE PROJECT SUPERVISOR PRIMARILY REFERS TO THE NOMINATED PROJECT SUPERVISOR AS APPOINTED BY DJANDAK.

DRAWINGS

ALL DIMENSIONS ARE TO BE VERIFIED ON SITE PRIOR TO COMMENCEMENT OF WORK. DO NOT SCALE FROM DRAWINGS. THESE DRAWINGS ARE TO BE READ IN CONJUNCTION WITH NOTES AND SUPPORTING DOCUMENTS. SEEK CLARIFICATION FROM THE PROJECT SUPERVISOR SHOULD ANY DISCREPANCIES BE FOUND IN THE PACKAGE.

AUSTRALIAN STANDARDS (AS)

THE CONTRACTOR AND ALL TRADES MUST UNDERTAKE WORKS IN ACCORDANCE WITH THE AUSTRALIAN STANDARDS (AS) PERTAINING TO THOSE TRADES. ALL CONSTRUCTION TO COMPLY WITH THE NATIONAL CONSTRUCTION CODE (NCC), INCLUDING BUT NOT LIMITED TO:

- CONCRETE STRUCTURES (AS3600-2018)
- SLAB & FOOTINGS (AS2870-2011)
- TREE STOCK FOR LANDSCAPE USE (AS2303)

OCCUPATIONAL HEALTH & SAFETY

THE CONTRACTOR IS TO SUBMIT TO THE PROJECT SUPERVISOR CONFIRMATION OF OCCUPATIONAL HEALTH & SAFETY (OHS) MANAGEMENT AND ACCREDITATION IN ACCORDANCE WITH THE DEPARTMENTS REQUIREMENTS AND VICTORIAN CONSTRUCTION SUPPLIER REGISTER (CSR).

HYDRAULIC SERVICES

ANY HYDRAULIC / PLUMBING WORKS ARE TO BE PERFORMED BY A LICENSED / REGISTERED PLUMBER. APPLY FOR PERMITS AND PAY REQUIRED FEES AND CHARGES TO RESPONSIBLE AUTHORITIES. PROVIDE PERMITS AND CERTIFICATES TO THE PROJECT SUPERVISOR ON COMPLETION OF WORKS.

DOCUMENTS REQUIRED PRIOR TO UNDERTAKING ANY WORKS

PRIOR TO UNDERTAKING ANY WORKS THE CONTRACTOR IS TO PROVIDE TO THE PROJECT SUPERVISOR A SITE MANAGEMENT PLAN THAT INCLUDES BUT IS NOT LIMITED TO THE FOLLOWING:

- PUBLIC SAFETY, AMENITY AND SITE SECURITY, INCLUDING LOCATIONS OF BARRIER FENCING AND SIGNAGE
- OPERATING HOURS
- NOISE AND VIBRATION CONTROLS
- AIR AND DUST MANAGEMENT
- STORMWATER AND SEDIMENT CONTROL
- WASTE AND MATERIALS REUSE, INCLUDING AREAS FOR STORAGE OF MATERIALS AND PLANT
- TRAFFIC MANAGEMENT, INCLUDING VEHICLE PARKING
- TEMPORARY SITE BUILDINGS
- SANITARY FACILITIES

CONTRACTOR TO COMPLY WITH WORKING HOURS STIPULATED IN THE LOCAL COUNCIL'S ORDINANCES AND EPA NOISE OMISSION GUIDELINES. ALL BUILDING WORKS ARE TO BE COMPLETED IN ACCORDANCE WITH THE BUILDING ACT 1993, BUILDING REGULATIONS 2006 AND RELEVANT BUILDING CODE INCLUDING NATIONAL CONSTRUCTION CODE (NCC).

PERMITS & FEES

THE CONTRACTOR IS TO ALLOW FOR ARRANGEMENT AND PAYMENT FOR ANY PERMITS AND / OR STATUTORY / AUTHORITY CHARGES REQUIRED TO COMPLETE THE WORKS.

INSURANCES

THE CONTRACTOR IS TO CONFIRM ALL INSURANCES ARE CURRENT AND VALID FOR THE PERIOD OF THE WORKS PRIOR TO COMMENCING. INCLUDING PUBLIC LIABILITY, PROFESSIONAL INDEMNITY AND WORKERS COMPENSATION.

MANUFACTURER SPECIFICATION

ALL WORKS, SUPPLY AND INSTALLATION OF PROPRIETARY EQUIPMENT / FURNITURE INVOLVING MANUFACTURED ITEMS / MATERIALS ARE TO BE INSTALLED IN ACCORDANCE WITH THE MANUFACTURER SPECIFICATION, REQUIREMENTS, MOUNTING HEIGHTS, CIRCULATION ZONES ETC. AS TO NOT VOID WARRANTIES AND TO COMPLY WITH AUSTRALIAN STANDARDS WHERE REQUIRED.

SITE CONDITIONS & PREPARATION (INCLUDING EARTHWORKS)

CONTRACTOR IS TO INFORM THEMSELVES OF ALL SITE CONDITIONS PRIOR TO SITE COMMENCEMENT MEETING.

CONTRACTOR TO ALLOW FOR ALL FILLING, GRADING AND TRIMMING, REMOVAL OF SPOIL, CLEANING, AND SURFACE PREPARATION FOR FINISHES AS SPECIFIED.

EXISTING & UNDERGROUND SERVICES

IT IS THE RESPONSIBILITY OF THE CONTRACTOR TO MAKE APPROPRIATE INVESTIGATIONS REGARDING THE EXACT LOCATION OF UNDERGROUND SERVICES PRIOR TO ANY CULTIVATION, RIPPING OR EXCAVATION. NO INFORMATION IS PROVIDED ON THE DRAWINGS REGARDING THE EXACT LOCATION OF EXISTING SERVICES. THE CONTRACTOR SHALL BE RESPONSIBLE FOR BEARING THE COST OF MAKING GOOD ANY DAMAGE TO EXISTING SERVICES AND MAINS, WHETHER OR NOT THESE ARE SHOWN ON THE DRAWINGS.

IT IS RECOMMENDED THAT SERVICES DETECTION MAPPING AND A DIAL BEFORE YOU DIG (DBYD) MAY BE REQUIRED. PROJECT SUPERVISOR IS TO DETERMINE IF THIS IS NECESSARY FOR THE SUBJECT SITE

EXISTING SERVICES MAY BE USED AS A TEMPORARY SERVICE TO UNDERTAKE THE WORKS WITH THE APPROVAL OF THE PROJECT SUPERVISOR. ALL CURRENT SERVICES ARE TO BE MAINTAINED AND MADE SAFE. IF THE SERVICES REQUIRE TEMPORARY DISCONNECTION THE CONTRACTOR IS TO RECONNECT AND MAKE GOOD.

SECURITY, PROTECTION AND FENCING

CONTRACTOR TO ENSURE SEPARATE AND SECURE ACCESS TO THE WORKS AREA FOR THE DURATION OF THE WORKS.

PROTECTION OF EXISTING TREES

WHERE MECHANICAL EXCAVATION IS PLANNED TREE PROTECTION FENCING IS TO BE PUT IN PLACE PRIOR TO THE COMMENCEMENT OF SITE WORKS AND REMAIN IN PLACE UNTIL ALL SITE WORKS HAVE BEEN COMPLETED. MECHANICAL EXCAVATION IS ONLY ALLOWED OUTSIDE OF TPZ'S. PROTECTIVE FENCING IS TO BE LABELLED 'TREE PROTECTION ZONE'. WHEN EXCAVATION IS REQUIRED WITHIN TPZ OF TREES TO BE RETAINED, USE HAND EXCAVATION TO LOCATE ANY ROOTS. TREE ROOTS EXCEEDING 30mm DIAMETER ARE SIGNIFICANT TREE ROOTS. WHERE IT IS NECESSARY TO CUT TREE ROOTS, CLEAN CUT USING SHARP HAND TOOLS. WHERE POSSIBLE ROOTS ARE TO BE CUT ON A 90° ANGLE MINIMISING THE SIZE OF THE AREA CUT. SEAL TREE ROOT CUTS WITH 'SERIPUNE' OR AN APPROVED EQUIVALENT TREE WOUND SEALANT OR ADVISED BY ARBORIST ONSITE.

GRADING & TRIMMING

ENSURE GRADING AND TRIMMING OF THE SUBGRADE LEVEL ALLOWS FOR THE SPECIFIED HEIGHTS OF THE SUBBASE AND FINISHING COURSE IN ACCORDANCE WITH LANDSCAPE DETAILS. FINISH OFF EXCAVATED AREAS WITH AN EVEN CONSISTENT SURFACE AND FILL DEPRESSIONS WITH SOUND MATERIAL.

USE MATERIAL EXCAVATED DURING THE TRIMMING AS GRADING WORKS AS FILL OR BASE MATERIAL IF DEEMED APPROPRIATE BY PROJECT SUPERVISOR. REMOVE EXCESS EXCAVATED MATERIAL OFF SITE.

ALL GRADING TO NATURAL DRAINAGE PATHS SHALL BE SMOOTH AND GRADUAL.

DAMAGE

LIMIT WORK ZONES TO MINIMIZE DISTURBANCE TO ADJACENT SURFACES AND DRAINAGE AREAS. ENSURE ANY CONSTRUCTION MATERIAL AND DEBRIS ARE DISPOSED OFF SITE APPROPRIATELY. DURING THE CONTRACT PERIOD, THE CONTRACTOR SHALL BE LIABLE TO RECTIFY / REPLACE MALICIOUS AND UNLAWFUL DAMAGE INSTRUCTED BY AND TO THE SATISFACTION OF THE PROJECT SUPERVISOR. THE CONTRACTOR SHALL BE LIABLE FOR THE COSTS OF RECTIFICATION OR AS AGREED WITH THE PROJECT SUPERVISOR. ANY DAMAGE TO EXISTING STRUCTURE, SERVICES, AND FINISHES OCCURRING / DURING THE WORKS MUST BE MADE GOOD. ANY DAMAGE TO COMPLETED WORK MUST BE MADE GOOD.

ESTABLISHMENT PERIOD

ESTABLISHMENT INCLUDES THE CARE OF THE CONTRACT AREAS BY ACCEPTED HORTICULTURAL PRACTICES, INCLUDING RECTIFYING ANY DEFECTS THAT BECOME APPARENT IN THE WORKS UNDER NORMAL USE. THIS SHALL INCLUDE, BUT SHALL NOT BE LIMITED TO, THE FOLLOWING ITEMS WHERE AND AS REQUIRED:

- WATERING, CULTIVATION, WEEDING, PESTS AND DISEASE CONTROL, STAKING, REPLACEMENT OF PLANT MATERIALS, REPLANTING, PRUNING, KEEPING THE SITE NEAT AND TIDY.
- MAKE GOOD SOIL SUBSIDENCE.
- ENSURE MULCHED SURFACES ARE KEPT IN A CLEAN AND TIDY CONDITION AND REINSTATE AND MAKE TIDY IF DISTURBED DURING WORKS PERIOD.

HARDSCAPE

CONCRETE PAVING PEDESTRIAN GRADE RAMP

CONCRETE PAVING SHALL CONSIST OF 125mm THICK INSITU CONCRETE OF APPROVED COLOUR. REINFORCING MESH IN ACCORDANCE WITH STANDARDS. FINISHED SURFACE TO BE SMOOTH AND EVEN, AND CONFORM TO ALL RELEVANT STANDARDS.

CONCRETE PAVING PEDESTRIAN GRADE EXPOSED AGGREGATE

CONCRETE PAVING SHALL CONSIST OF 125mm THICK INSITU EXPOSED AGGREGATE CONCRETE OF APPROVED COLOUR. REINFORCING MESH IN ACCORDANCE WITH DOCUMENTATION OR EQUIVALENT STANDARD DETAIL. FINISHED SURFACE TO BE SMOOTH AND EVEN, AND CONFORM TO ALL RELEVANT STANDARDS. A 'WARM' LOCAL AGGREGATE, **APPROPRIATE TO COUNTRY**, SHOULD BE SELECTED WITH THE APPROVAL OF THE PROJECT SUPERVISOR.

STONE PAVING BAND

MORTARED LOCAL STONE PAVING SET FLUSH WITH EXPOSED AGGREGATE CONCRETE ALONG DRIPLINE AS SHOWN ON DRAWING. STONE TO MATCH 'RUSTIC STONE RETAINING WALL' STONE CHOICE. SAWN STONE FACE TO BE FREE FROM TRIP HAZARDS. APPROPRIATE SLIP RATING TO BE CONSIDERED BASED ON AUSTRALIAN STANDARDS.

STEEL STEPS (CASTLEMAINE ONLY)

STEEL STEPS TO BE ROLLED OFF SITE, TO SPECIFICATIONS AS PER DETAIL SKETCH, AND WELDED, GROUND SMOOTH AND PINNED ON SITE. TO BE FILLED WITH COMPACTED TOPPING. ENSURE NO BURRS OR SHARP EDGES.

LOCAL TOPPING

WEARING COURSE OF MINIMUM 50mm COMPACTED DEPTH CEMENT STABILISED WARM LOCAL TOPPING MIX, APPROPRIATE TO COUNTRY, SHOULD BE SELECTED WITH THE APPROVAL OF THE PROJECT SUPERVISOR. TO BE INSTALLED IN TWO 25mm LAYERS, EACH LAYER TO BE WATERED IN AND COMPACTED PROGRESSIVELY. THE FINISHED SURFACE SHALL BE CROWNED, FREE DRAINING, NOT LIABLE TO PONDING EITHER OR AT PATH EDGES. FLUSH WITH ALL ADJOINING EDGES AND WELL COMPACTED. WORK WITHIN NO DIG ZONE TO INCLUDE A SUBBASE OF NO FINES CONCRETE AS DETAILED AND IN ACCORDANCE WITH RELEVANT REQUIREMENTS

GRAVEL / LOCAL TOPPING - 'MAKE GOOD'

AREAS OF GRAVEL AND TOPPING MARKED AS 'MAKE GOOD' TO BE GRADED TO REMOVE RUTS, AND TOPPED UP AS APPROPRIATE WITH TOPPING AS SELECTED ABOVE

LOGS

LOGS TO BE TAKEN FROM DJANDAK STOCKPILE OR BE MATERIALS FROM REMOVED SITE TREES. TO BE STRIPPED OF BARK AND MADE SPLINTER FREE WHERE THEY WOULD BE SUITABLE FOR SEATING.

BOULDERS

LOCAL STONE TO BE USED. TO BE BURIED AT LEAST ¼ INTO THE GROUND AND BE SECURED.

CUT TOP BOULDERS

LOCAL STONE TO BE USED. TOP CUT FLAT TO PROVIDE SEATING. ANY SHARP EDGES TO BE REMOVED.

FURNITURE TREATMENTS

FURNITURE TO BE INSTALLED AS PER MANUFACTURER'S INSTRUCTIONS (**WILL WE BE ABLE TO USE THE DJANDAK SUITE?**)

SOFTSCAPE

TIMBER GARDEN MULCH

SUPPLY AND SPREAD 75MM DEPTH OF APPROVED RECYCLED TIMBER MULCH TO SPECIFIED PLANTING AREAS. TRIM AND GRADE AND ENSURE THAT MULCH TAPERS TO BASE OF TREES AND PLANTS.

PLANTING PREPARATION - FOOD AND FIBER FEATURE

CAREFULLY PREPARE PLANTING BED BY HAND DIGGING WHERE NECESSARY, BEING CAREFUL OF TREES AND ROOTS. AN IMPORTED 'NATIVE PLANT' SOIL MIX, APPROPRIATE TO COUNTRY AND THE GROWING OF FOOD AND FIBER PLANTS, SHOULD BE SELECTED WITH THE APPROVAL OF THE PROJECT SUPERVISOR. APPROXIMATELY 150mm DEPTH SOIL TO BE INCORPORATED CAREFULLY INTO EXISTING SITE SOIL BEFORE PLANTING.

PLANTING PREPARATION - REGENERATION, SWALE & WATERS EDGE

PREPARE AREA BY HAND DIGGING INDIVIDUAL HOLES IN ACCORDANCE WITH BEST REGENERATIVE PRACTICES AND IN ACCORDANCE WITH THE RELEVANT MANAGEMENT PLAN.

PLANTING

SUPPLY AND INSTALL PLANTING AS SHOWN. SET OUT OF PLANTING TO BE CONFIRMED AND APPROVED BY SUPERINTENDENT PRIOR TO INSTALLATION. REFER PLANT SCHEDULE AND PLANTING PLANS. TICKLE THE ROOT BALL OF EACH PLANT IN ORDER TO FREE ROOTS FROM POTTING MIXTURES. ENSURE OVER EXCAVATE PLANTING HOLES SLIGHTLY LARGER THAN ROOTBALL AS DETAILED. WATER IMMEDIATELY AFTER PLANTING WITH AT LEAST 4 LITRES OF

NOTE: ALL TEXT IN PINK TO BE REVIEWED

POLLEN

Pollen Studio Pty Ltd - Landscape Architects
BRUNSWICK - Siteworks
Studio 1 | Level 1 | 33 Saxon Street VIC 3056
03 9329 7548 | pollen@pollenstudio.com.au
pollenstudio.com.au | ABN 45 494 020 124

PROJECT
BALAK KALIK MANYA WALKING TOGETHER - Kalimna Park
Landscape Works
CLIENT
Djandak | Dja Dja Wurrung Clans Aboriginal Corporation

CLIENT REFERENCE
-

JOB NUMBER
201102

PHASE
Detailed Concept Plans for Documentation
DRAFT
DRAWING TITLE
Performance Notes

REV.	COMMENT	DATE
A	DRAFT DETAILED CONCEPT FOR REVIEW	02.08.21
B	FOR CONSTRUCTION	15.09.21

DRAWN **BB**

CHECK **FH**

SCALE

-

SHEET

2 of 14

DRAWING NO.

LDD-100

ISSUE

2

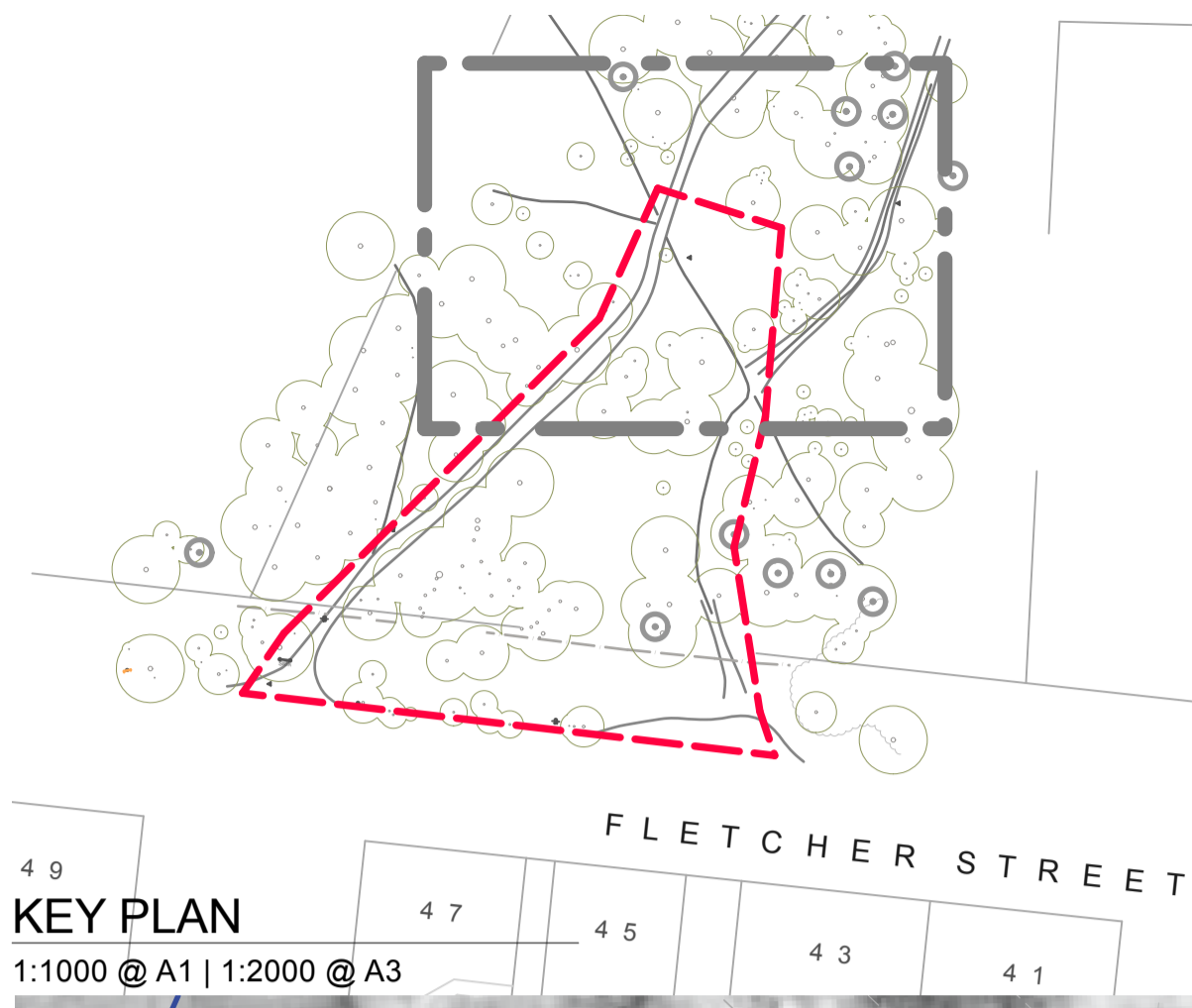

- LEGEND**
- EXTENT OF WORKS**
LANDSCAPE WORKS
 - EXTENT OF PARKS VICTORIA LAND**
TITLE BOUNDARY
 - EXISTING**
 - TREE TO BE RETAINED**
EXISTING TREES TO BE RETAINED (FROM SURVEY)
 - DEAD TREE TO BE RETAINED**
TO BE RETAINED AND PROTECTED (FROM SURVEY)
 - DEAD TREE TO BE REMOVED**
STOCKPILE LOGS FOR USE ON SITE
 - EXISTING FENCE**
EXISTING FENCE TO BE RETAINED AND PROTECTED
 - PROPOSED**
 - MINOR EARTHWORKS ZONE**
MINOR TRIMMING AND GRADING TO MEET DESIGN LEVELS (MAXIMUM +/- 150MM FROM EXISTING SURFACE LEVELS)
 - CUT/FILL ZONE**
APPROXIMATE AREA OF CUT/FILL TO MEET DESIGN LEVELS (DEPTH VARIES +/- 150MM-550MM FROM EXISTING LEVELS)
 - GARDEN BED CULTIVATION ZONE**
APPROXIMATE AREA TO BE CULTIVATED BY HAND IN PREPARATION FOR PLANTING. TAKE CARE NOT TO DAMAGE TREES OR ROOTS.

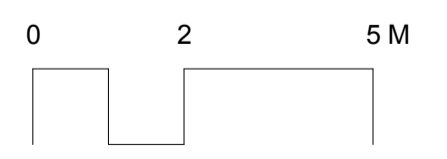

POLLEN

Pollen Studio Pty Ltd - Landscape Architects
BRUNSWICK - Siteworks
Studio 1 | Level 1 | 33 Saxon Street VIC 3056
03 9329 7548 | pollen@pollenstudio.com.au
pollenstudio.com.au | ABN 45 494 020 124

PROJECT
BALAK KALIK MANYA WALKING TOGETHER - Kalimna Park
Landscape Works
CLIENT
Djandak | Dja Dja Wurrung Clans Aboriginal Corporation

CLIENT REFERENCE
-
JOB NUMBER
201102

PHASE
Detailed Concept Plans for Documentation
DRAFT
DRAWING TITLE
Existing Conditions & Demolition

REV.	COMMENT	DATE
A	DRAFT DETAILED CONCEPT FOR REVIEW	02.08.21
B	FOR CONSTRUCTION	15.09.21

DRAWN BB **CHECK** FH

SCALE
1:100 @ A1 | 1:200 @ A3
SHEET
3 of 14
DRAWING NO.
LDD-200

NORTH

ISSUE
2

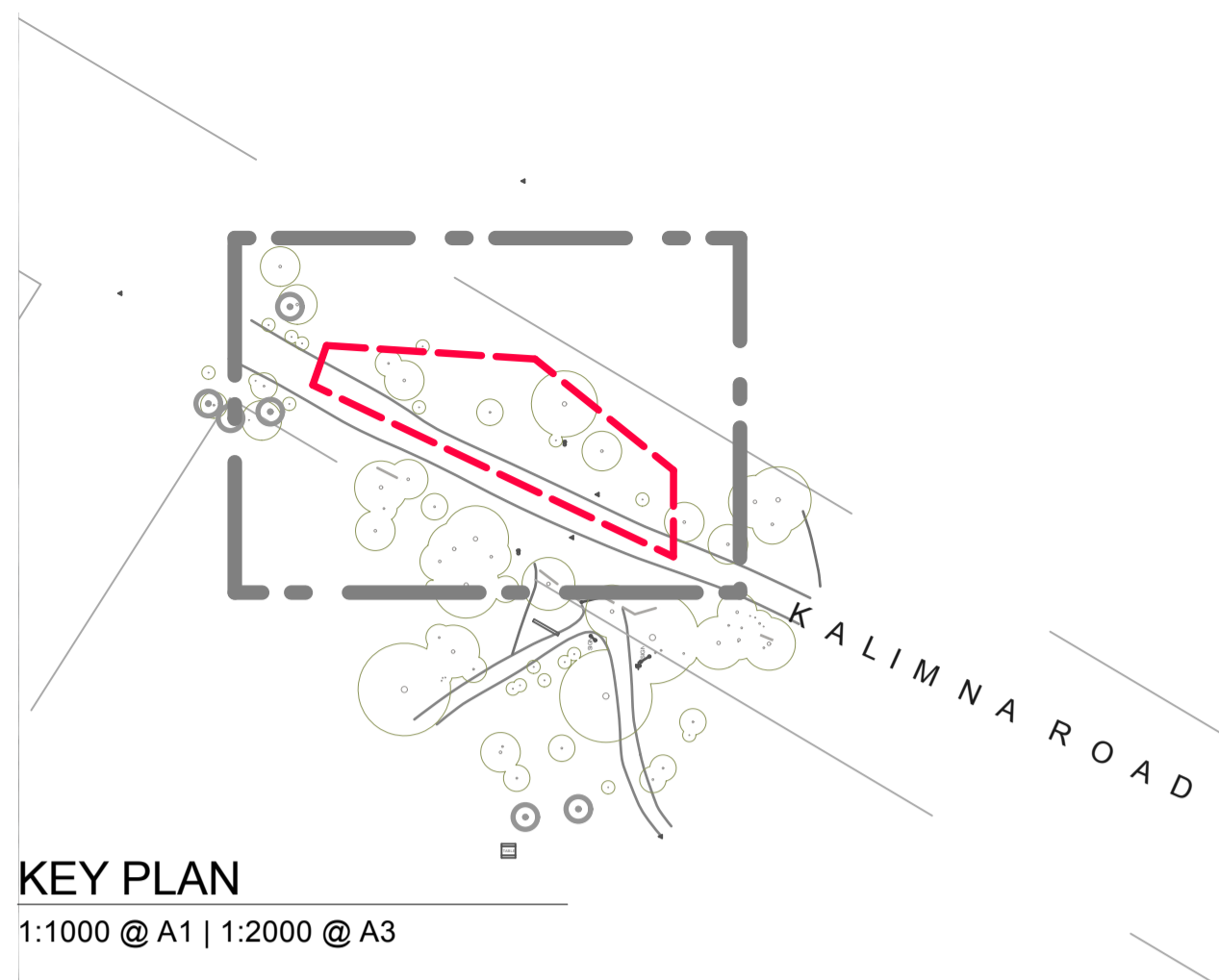

LEGEND

- - - **EXTENT OF WORKS**
LANDSCAPE WORKS
- - - **EXTENT OF PARKS VICTORIA LAND**
TITLE BOUNDARY
- EXISTING**
- TREE TO BE RETAINED**
EXISTING TREES TO BE RETAINED (FROM SURVEY)
- + **DEAD TREE TO BE RETAINED**
TO BE RETAINED AND PROTECTED (FROM SURVEY)
- EXISTING FENCE**
EXISTING FENCE TO BE RETAINED AND PROTECTED
- PROPOSED**
- MINOR EARTHWORKS ZONE**
MINOR TRIMMING AND GRADING TO MEET DESIGN LEVELS (MAXIMUM +/- 150MM FROM EXISTING SURFACE LEVELS)
- CUT/FILL ZONE**
APPROXIMATE AREA OF CUT/FILL TO MEET DESIGN LEVELS (DEPTH VARIES +/- 150MM-550MM FROM EXISTING LEVELS)

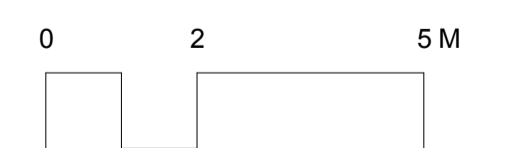

POLLEN

Pollen Studio Pty Ltd - Landscape Architects
BRUNSWICK - Siteworks
Studio 1 | Level 1 | 33 Saxon Street VIC 3056
03 9329 7548 | pollen@pollenstudio.com.au
pollenstudio.com.au | ABN 45 494 020 124

PROJECT
BALAK KALIK MANYA WALKING TOGETHER - Kalimna Park
Landscape Works
CLIENT
Djandak | Dja Dja Wurrung Clans Aboriginal Corporation

CLIENT REFERENCE
-
JOB NUMBER
201102

PHASE
Detailed Concept Plans for Documentation
DRAFT
DRAWING TITLE
Existing Conditions & Demolition

REV.	COMMENT	DATE
A	DRAFT DETAILED CONCEPT FOR REVIEW	02.08.21
B	FOR CONSTRUCTION	15.09.21

DRAWN **BB** CHECK **FH**

SCALE
1:100 @A1 1:200 @A3
SHEET
4 of 14
DRAWING NO.
LDD-202

NORTH

ISSUE
2

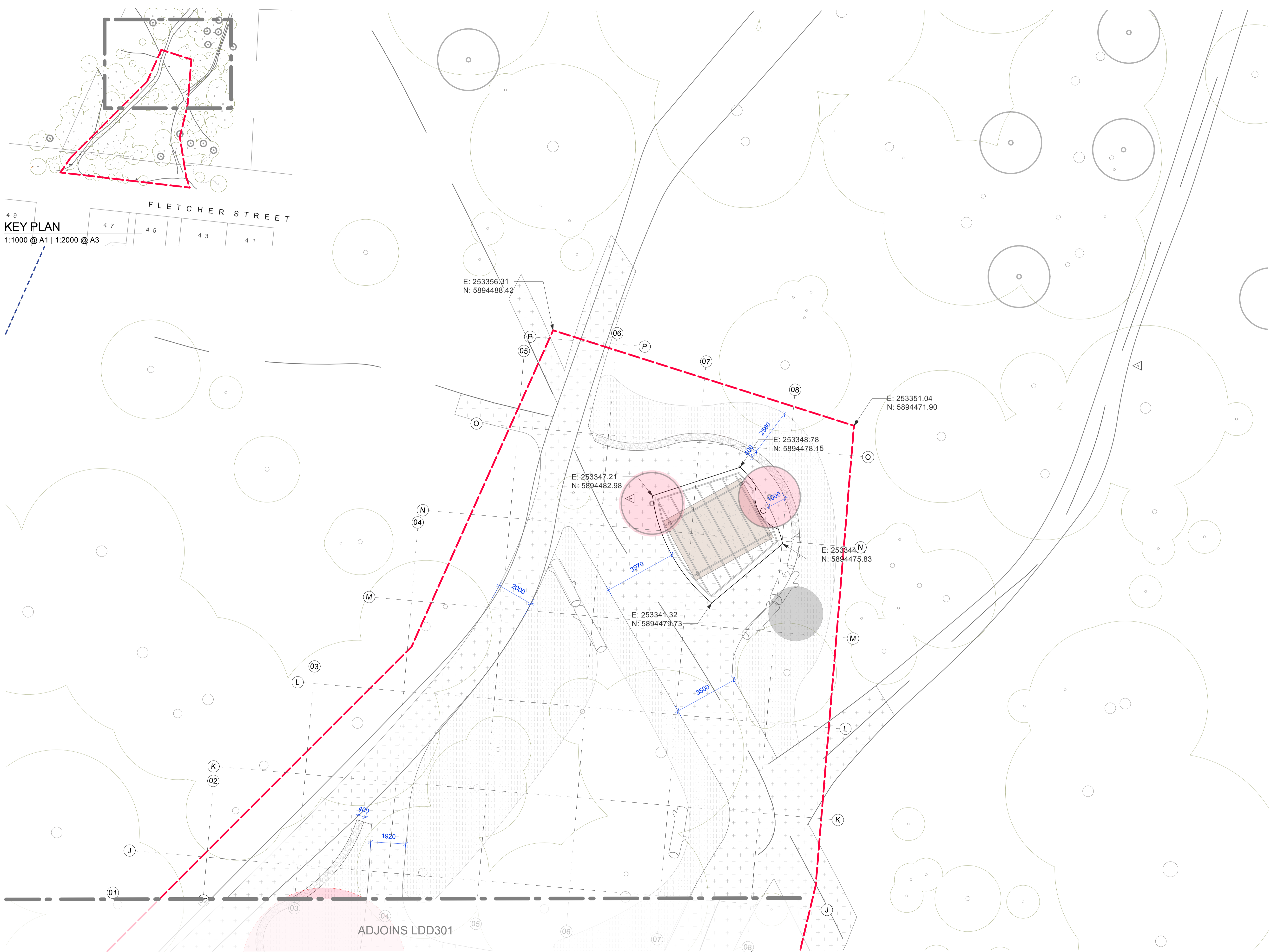

- LEGEND**
- - - EXTENT OF WORKS
LANDSCAPE WORKS
 - - - EXTENT OF PARKS VICTORIA LAND
TITLE BOUNDARY
 - SET OUT GRID
SET OUT GRID TO BE APPROVED BY PM ON SITE
 - EXISTING**
 - TREE TO BE RETAINED
EXISTING TREES TO BE RETAINED
(FROM SURVEY)
 - DEAD TREE TO BE RETAINED
TO BE RETAINED AND PROTECTED
(FROM SURVEY)
 - DEAD TREE TO BE REMOVED
STOCKPILE LOGS FOR USE ON SITE

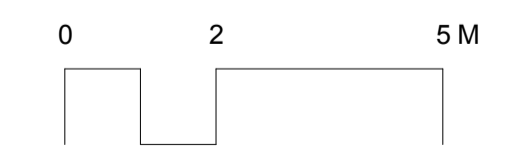

POLLEN

Pollen Studio Pty Ltd - Landscape Architects
BRUNSWICK - Siteworks
Studio 1 | Level 1 | 33 Saxon Street VIC 3056
03 9329 7548 | pollen@pollenstudio.com.au
pollenstudio.com.au | ABN 45 494 020 124

PROJECT
BALAK KALIK MANYA WALKING TOGETHER - Kalimna Park
Landscape Works
CLIENT
Djandak | Dja Dja Wurrung Clans Aboriginal Corporation

CLIENT REFERENCE
-
JOB NUMBER
201102

PHASE
Detailed Concept Plans for Documentation
DRAFT
DRAWING TITLE
Set Out

REV.	COMMENT	DATE
A	DRAFT DETAILED CONCEPT FOR REVIEW	02.08.21
B	FOR CONSTRUCTION	15.09.21

DRAWN **BB** CHECK **FH**

SCALE
1:100 @ A1 | 1:200 @ A3
SHEET
5 of 14
DRAWING NO.
LDD-300

NORTH

ISSUE
2

LEGEND

- - - EXTENT OF WORKS
LANDSCAPE WORKS
- - - EXTENT OF PARKS VICTORIA LAND
TITLE BOUNDARY
- EXISTING
- TREE TO BE RETAINED
EXISTING TREES TO BE RETAINED
(FROM SURVEY)
- DEAD TREE TO BE RETAINED
TO BE RETAINED AND PROTECTED
(FROM SURVEY)

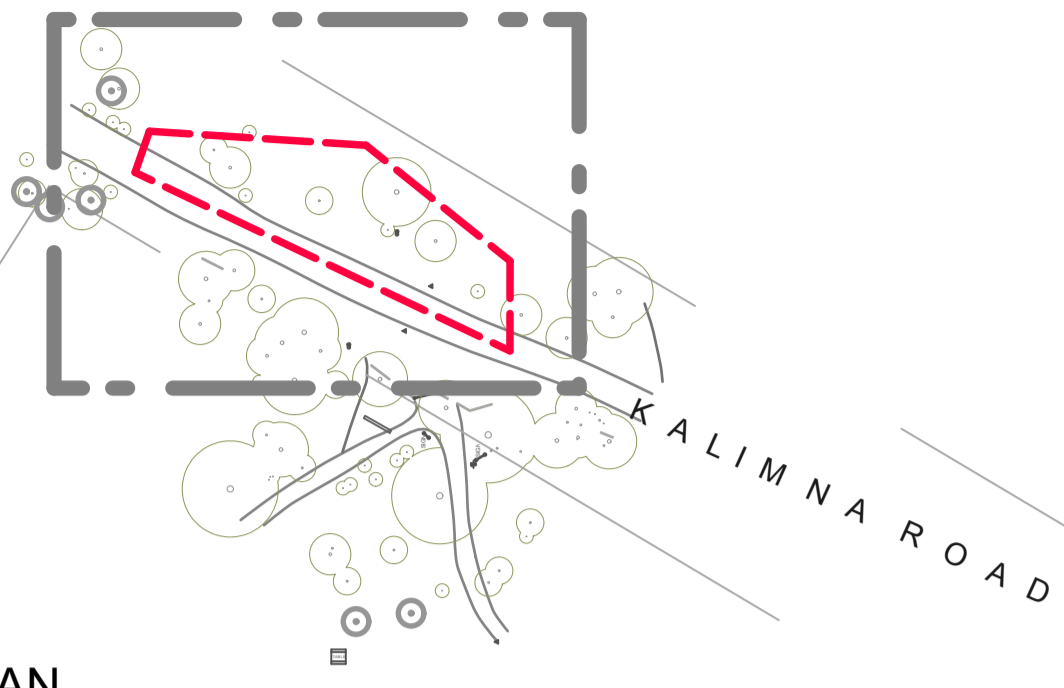

KEY PLAN
1:1000 @ A1 | 1:2000 @ A3

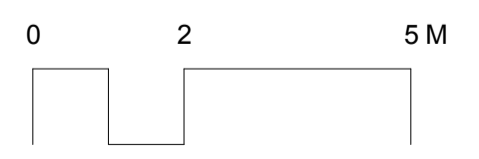
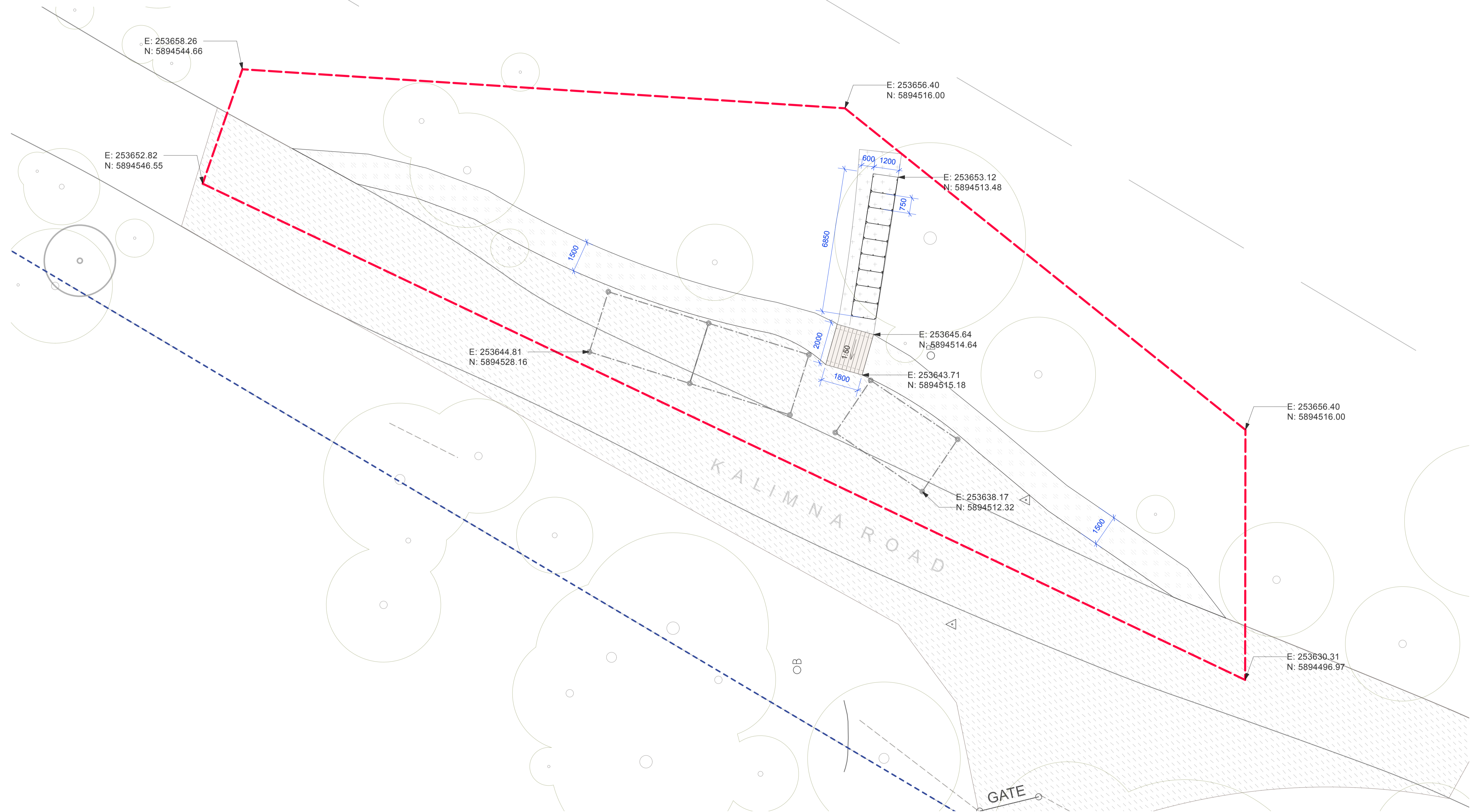

POLLEN

Pollen Studio Pty Ltd - Landscape Architects
 BRUNSWICK - Siteworks
 Studio 1 | Level 1 | 33 Saxon Street VIC 3056
 03 9329 7548 | pollen@pollenstudio.com.au
 pollenstudio.com.au | ABN 45 494 020 124

PROJECT
BALAK KALIK MANYA WALKING TOGETHER - Kalimna Park
 Landscape Works
CLIENT
 Djandak | Dja Dja Wurrung Clans Aboriginal Corporation

CLIENT REFERENCE
 -
JOB NUMBER
 201102

PHASE
Detailed Concept Plans for Documentation
 DRAFT
DRAWING TITLE
Set Out

REV.	COMMENT	DATE
A	DRAFT DETAILED CONCEPT FOR REVIEW	02.08.21
B	FOR CONSTRUCTION	15.09.21

DRAWN BB **CHECK** FH

SCALE
 1:100 @A1 1:200 @A3
SHEET
 7 of 14
DRAWING NO.
LDD-302

NORTH

ISSUE
2

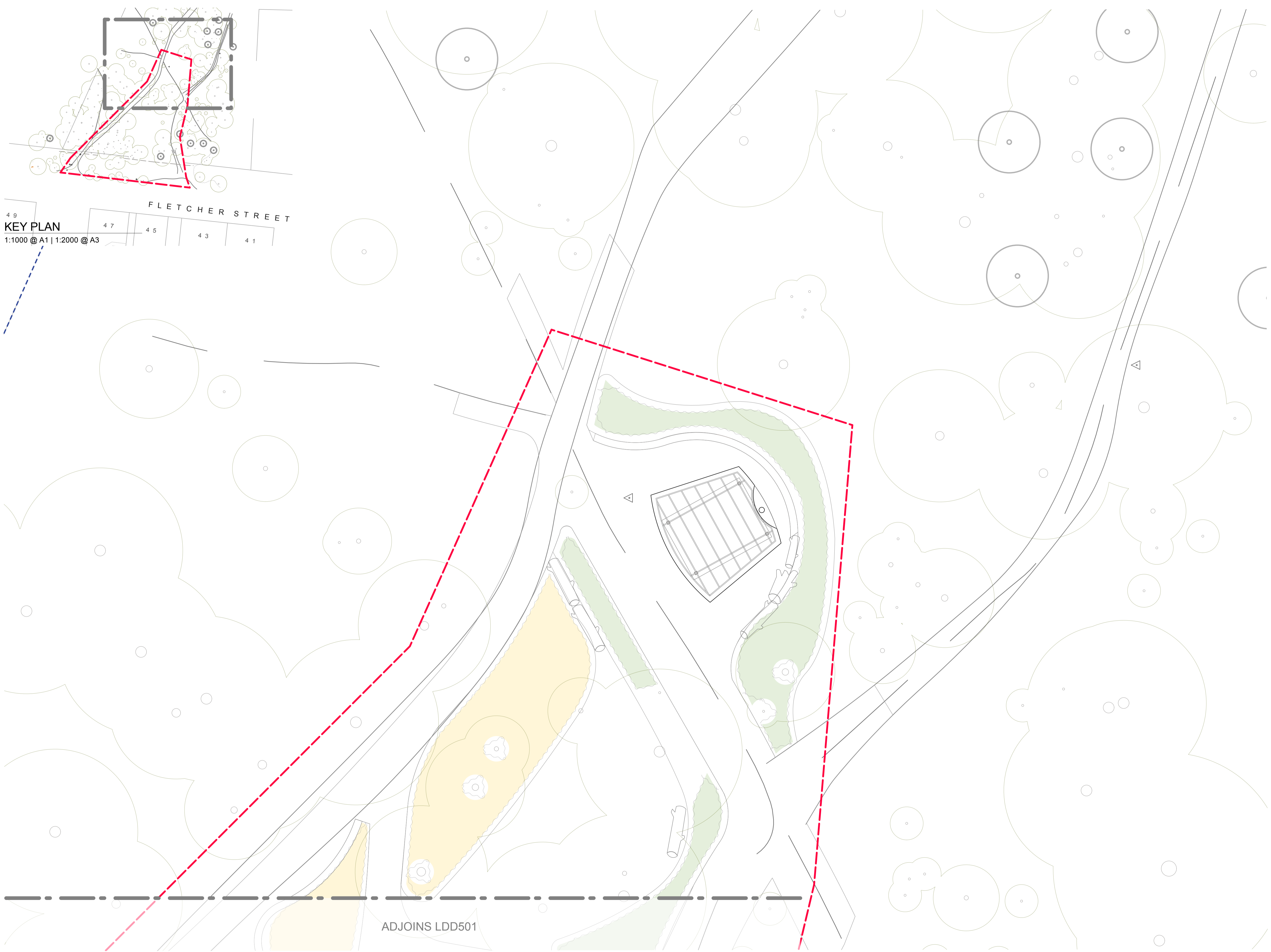

- LEGEND**
- EXTENT OF WORKS
LANDSCAPE WORKS
 - EXTENT OF PARKS VICTORIA LAND
TITLE BOUNDARY
- EXISTING
- TREE TO BE RETAINED
EXISTING TREES TO BE RETAINED
(FROM SURVEY)
 - DEAD TREE TO BE RETAINED
TO BE RETAINED AND PROTECTED
(FROM SURVEY)
- PROPOSED
- INFILL REGENERATION PLANTING
REFER PLANT SCHEDULE
 - FOOD & FIBER FEATURE PLANTING
REFER PLANT SCHEDULE

ADJOINS LDD501



POLLEN

Pollen Studio Pty Ltd - Landscape Architects
BRUNSWICK - Siteworks
Studio 1 | Level 1 | 33 Saxon Street VIC 3056
03 9329 7548 | pollen@pollenstudio.com.au
pollenstudio.com.au | ABN 45 494 020 124

PROJECT
**BALAK KALIK MANYA WALKING
TOGETHER - Kalimna Park**
Landscape Works
CLIENT
**Djandak | Dja Dja Wurrung Clans
Aboriginal Corporation**

CLIENT REFERENCE
-
JOB NUMBER
201102

PHASE
**Detailed Concept Plans
for Documentation**
DRAFT
DRAWING TITLE
**Planting Plan &
Schedule**

REV. COMMENT	DATE
A DRAFT DETAILED CONCEPT FOR REVIEW	02.08.21
B FOR CONSTRUCTION	15.09.21
DRAWN BB	CHECK FH

SCALE
1:100 @A1 1:200 @A3
SHEET
11 of 14
DRAWING NO.
LDD-500

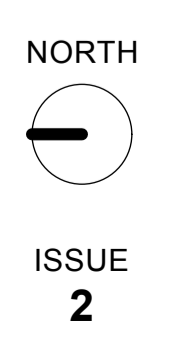

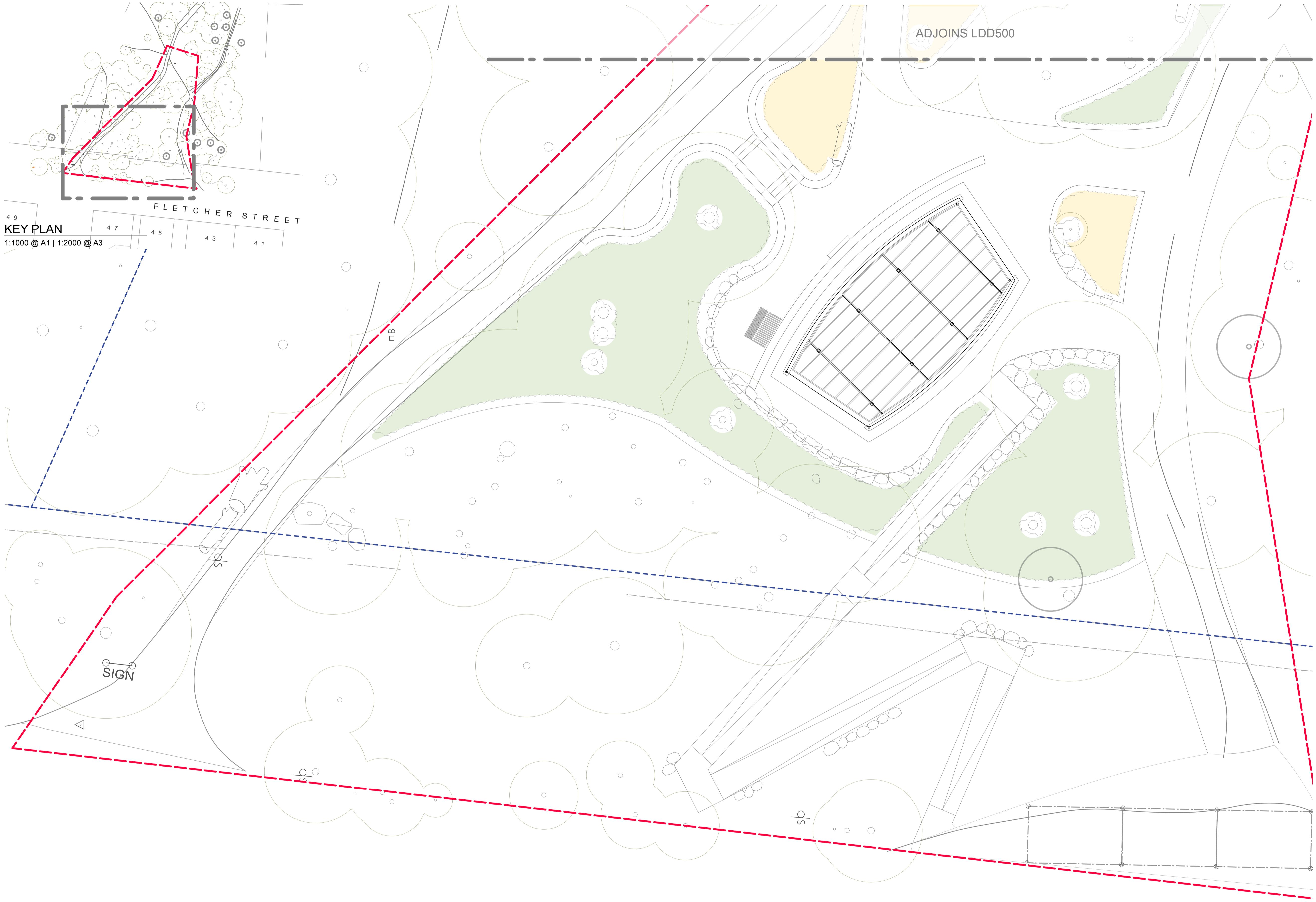
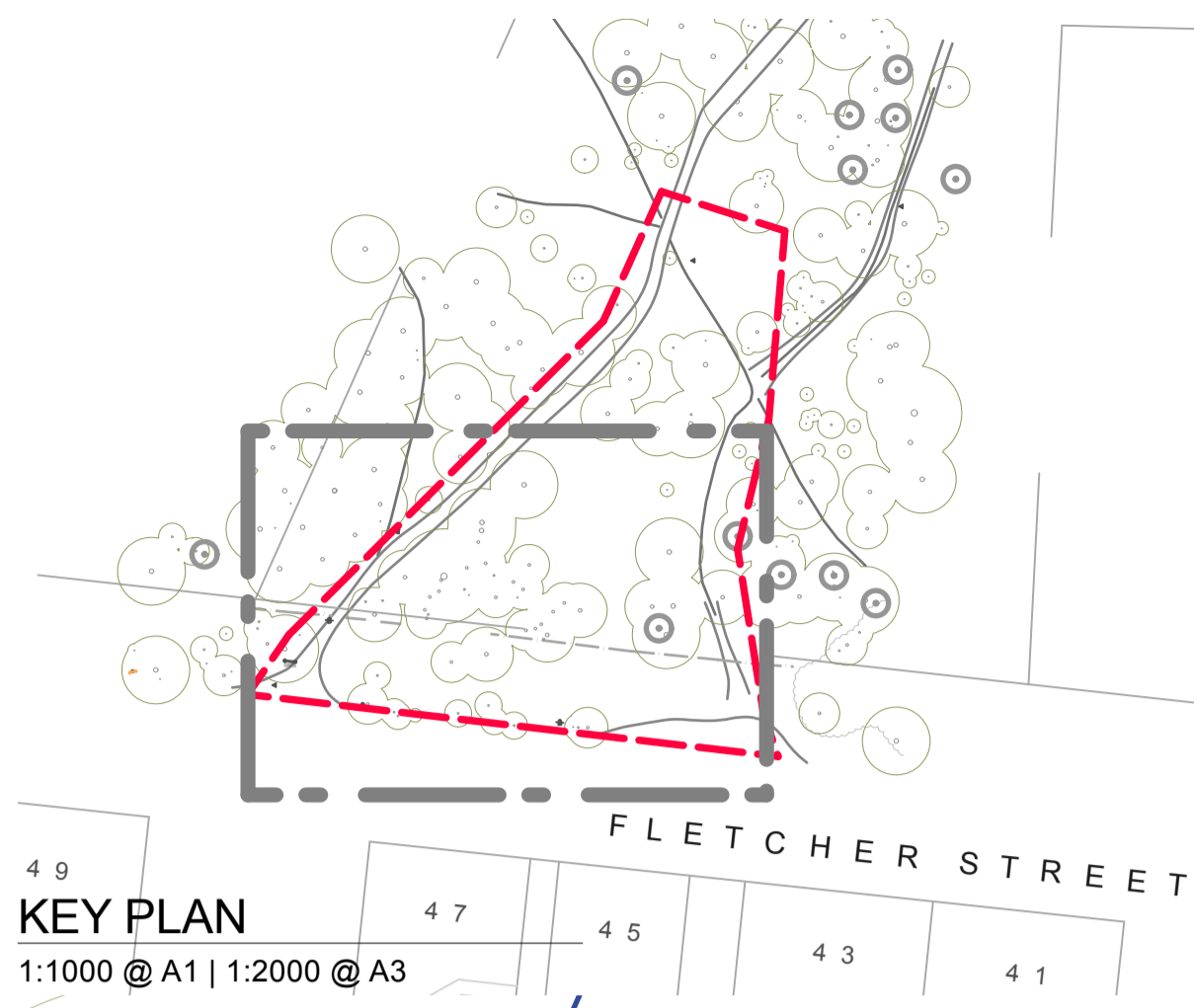

- LEGEND**
- EXTENT OF WORKS
LANDSCAPE WORKS
 - EXTENT OF PARKS VICTORIA LAND
TITLE BOUNDARY
- EXISTING
- TREE TO BE RETAINED
EXISTING TREES TO BE RETAINED
(FROM SURVEY)
 - DEAD TREE TO BE RETAINED
TO BE RETAINED AND PROTECTED
(FROM SURVEY)
- PROPOSED
- INFILL REGENERATION PLANTING
REFER PLANT SCHEDULE
 - FOOD & FIBER FEATURE PLANTING
REFER PLANT SCHEDULE

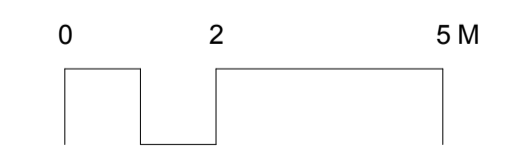

POLLEN

Pollen Studio Pty Ltd - Landscape Architects
BRUNSWICK - Siteworks
Studio 1 | Level 1 | 33 Saxon Street VIC 3056
03 9329 7548 | pollen@pollenstudio.com.au
pollenstudio.com.au | ABN 45 494 020 124

PROJECT
BALAK KALIK MANYA WALKING TOGETHER - Kalimna Park
Landscape Works
CLIENT
Djandak | Dja Dja Wurrung Clans Aboriginal Corporation

CLIENT REFERENCE
-

JOB NUMBER
201102

PHASE
Detailed Concept Plans for Documentation
DRAFT
DRAWING TITLE
Planting Plan & Schedule

REV.	COMMENT	DATE
A	DRAFT DETAILED CONCEPT FOR REVIEW	02.08.21
B	FOR CONSTRUCTION	15.09.21

DRAWN **BB** CHECK **FH**

SCALE
1:100 @ A1 1:200 @ A3
SHEET
12 of 14
DRAWING NO.
LDD-501

NORTH

ISSUE
2

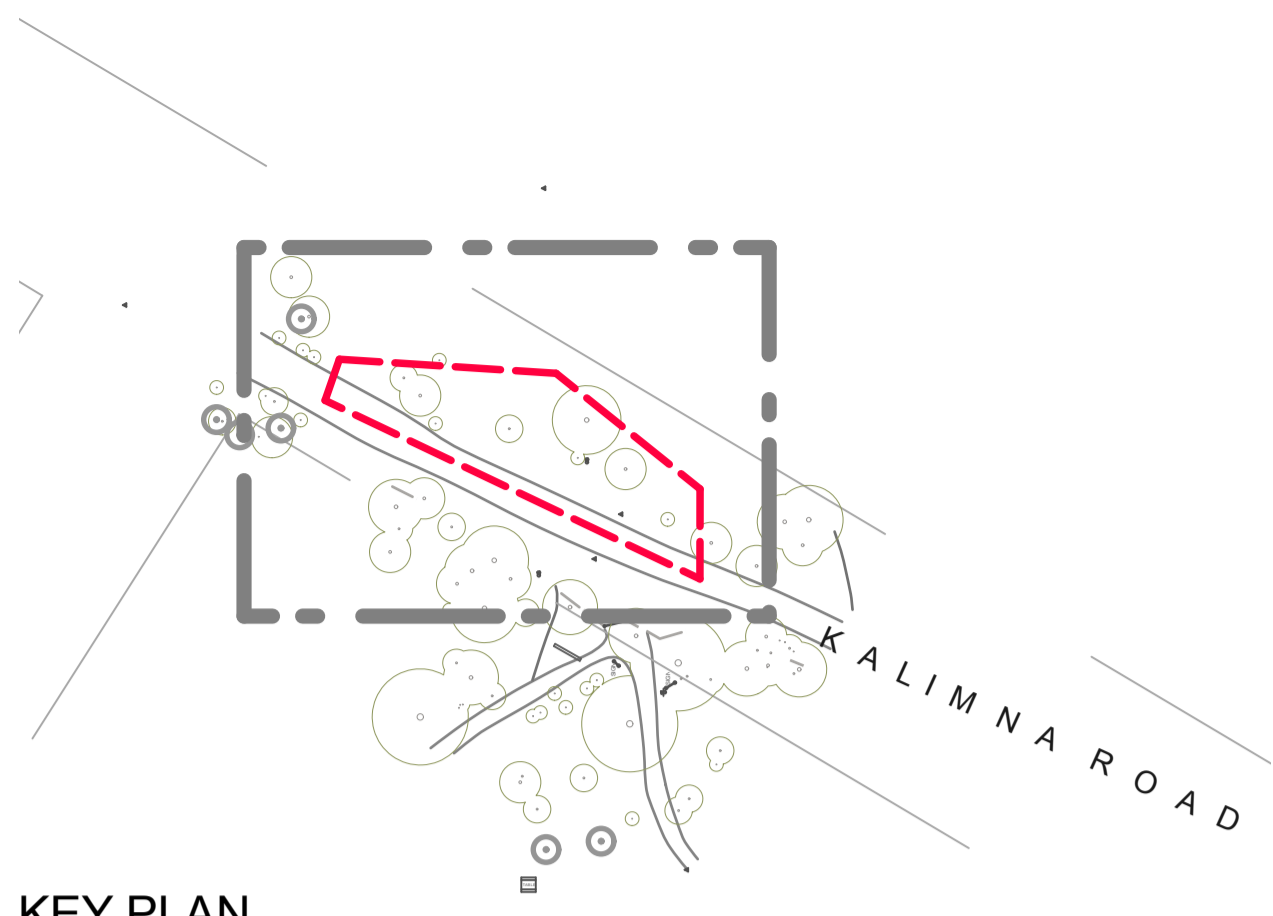

KEY PLAN
1:1000 @ A1 | 1:2000 @ A3

LEGEND

- - - **EXTENT OF WORKS**
LANDSCAPE WORKS
- - - **EXTENT OF PARKS VICTORIA LAND**
TITLE BOUNDARY
- EXISTING**
- TREE TO BE RETAINED**
EXISTING TREES TO BE RETAINED
(FROM SURVEY)
- DEAD TREE TO BE RETAINED**
TO BE RETAINED AND PROTECTED
(FROM SURVEY)
- PROPOSED**
- SWALE PLANTING**
REFER PLANT SCHEDULE

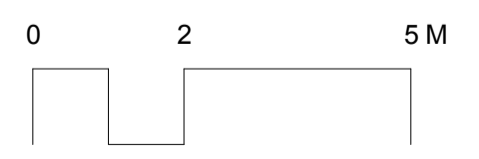
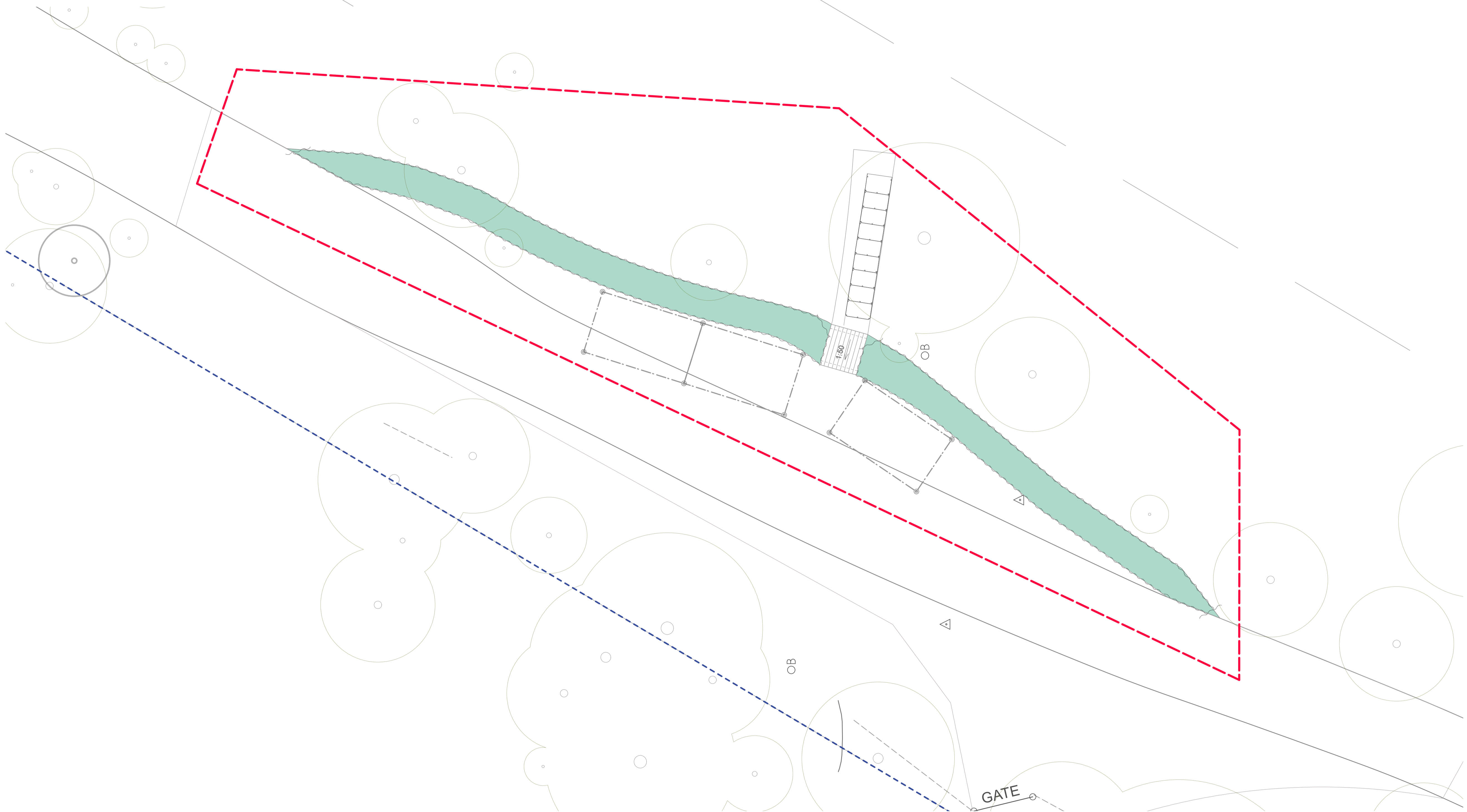

POLLEN

Pollen Studio Pty Ltd - Landscape Architects
BRUNSWICK - Siteworks
Studio 1 | Level 1 | 33 Saxon Street VIC 3056
03 9329 7548 | pollen@pollenstudio.com.au
pollenstudio.com.au | ABN 45 494 020 124

PROJECT
BALAK KALIK MANYA WALKING
TOGETHER - Kalimna Park
Landscape Works
CLIENT
Djandak | Dja Dja Wurrung Clans
Aboriginal Corporation

CLIENT REFERENCE
-
JOB NUMBER
201102

PHASE
**Detailed Concept Plans
for Documentation**
DRAFT
DRAWING TITLE
**Planting Plan &
Schedule**

REV.	COMMENT	DATE
A	DRAFT DETAILED CONCEPT FOR REVIEW	02.08.21
B	FOR CONSTRUCTION	15.09.21

DRAWN BB **CHECK** FH

SCALE
1:100 @A1 1:200 @A3
SHEET
13 of 14
DRAWING NO.
LDD-502

NORTH

ISSUE
2

PLANTING SCHEDULE

	CODE	LOCAL NAME	BOTANICAL NAME	COMMON NAME	MATURE H(m) x W(m)	POT SIZE	SPACING	QTY
TREES								
	EUC div		<i>Eucalyptus dives</i>	Broad-leaved Peppermint	16 x 12	140mm	as shown	x
	EUC gon		<i>Eucalyptus goniocalyx s.l.</i>	Long-leaf Box	14 x 12	140mm	as shown	x
	EUC mac		<i>Eucalyptus macrorhyncha</i>	Red Stringybark	20 x 15	140mm	as shown	x
	EUC man		<i>Eucalyptus mannifera ssp. mannifera</i>	Brittle Gum	18 x 14	140mm	as shown	x
	EUC pol		<i>Euucalyptus Polyanthemus</i>	Red Box	20 x 13	140mm	as shown	x
In Fill Regeneration Planting								
	ACR ser		<i>Acrotriche serrulata</i>	Honey Pots	0.3 x 1	Tubestock	3/m2	x
	DIA rev	<i>Wurrkuk</i>	<i>Dianella revoluta s.l.</i>	Black-Anther Flax Lily	0.5 x 0.5	Tubestock	6/m2	x
	EPA imp		<i>Epacris impressa</i>	Common Heath	1 x 1	Tubestock	3/m2	x
	JOY pal		<i>Joycea pallida</i>	Silvertop Wallaby-grass	1.2 x 0.5	Tubestock	6/m2	x
	LOM fil		<i>Lomandra filiformis</i>	Wattle Matt-rush	0.5 x 0.3	Tubestock	6/m2	x
	MON sco		<i>Monotoca scoparia</i>	Prickly Broom-heath	2 x 2	Tubestock	3/m2	x
	POA sie		<i>Poa sieberiana</i>	Grey Tussock-grass	0.8 x 0.5	Tubestock	6/m2	x
	PUL gun		<i>Pultenaea gunnii</i>	Golden Bush-pea	1.5 x 1.5	Tubestock	3/m2	x
	PUL hum		<i>Pultenaea humilis</i>	Dwarf Bush-pea	0.8 x 1	Tubestock	3/m2	x
	STY gra	<i>Bakap</i>	<i>Xanthorrhoea australis</i>	Grass Tree	3 x 2.5	140mm	4/m2	x
Food and Fiber Feature Planting								
	AUS mol		<i>Austrostipa mollis</i>	Supple Spear-Grass	1.2 x 0.5	Tubestock	6/m2	x
	BIL cym	<i>Dhurrungmil Wawitji</i>	<i>Billardiera cymosa</i>	Sweet-Apple Berry	2 x 3	Tubestock	4/m2	x
	COP qua		<i>Coprosma quadrifida</i>	Prickly Current-Bush	4 x 1.5	Tubestock	4/m2	x
	DIL ser		<i>Dillwynia sericea</i>	Showy Parrot Pea	1.5 x 2	Tubestock	3/m2	x
	DOD vis	<i>Mayn-mayn Durrung</i>	<i>Dodonaea viscosa</i>	Sticky Hop Bush	3 x 1.5	Tubestock	3/m2	x
	GAH sie		<i>Gahnia sieberiana</i>	Saw-sedge	1.5 x 3	Tubestock	4/m2	x
	IND aus		<i>Indigofera australis</i>	Australian Indigo	1.5 x 3	Tubestock	3/m2	x
	KUN eri		<i>Kunzea ericoides</i>	White Tea-Tree	5 x 4	Tubestock	3/m2	x
	LEP lan		<i>Leptospermum lanigerum</i>	Wolly Tea-Tree	4 x 3	Tubestock	3/m2	x
	LOM lon	<i>Witji</i>	<i>lomandra longifolia</i>	Spiny-headed Mat-rush	0.4 x 0.6	Tubestock	6/m2	x
Swale Planting								
	BAU art		<i>Baumea articulata</i>	Jointed Twig Rush	2 x 1	Tubestock	6/m2	x
	CAR app	<i>Witji</i>	<i>Carex appressa</i>	Tall Sedge	1 x 1	Tubestock	6/m2	x
	DIA rev	<i>Wurrkuk</i>	<i>Dianella revoluta</i>	Black-anther Flax-lily	0.5 x 0.5	Tubestock	6/m2	x
	JUN pal		<i>Juncus pallidus</i>	Pale Rush	1 x 1	Tubestock	6/m2	x