

PART SECTION OF EXISTING PATHWAY ILLUMINATION RESULTS
N.T.S.

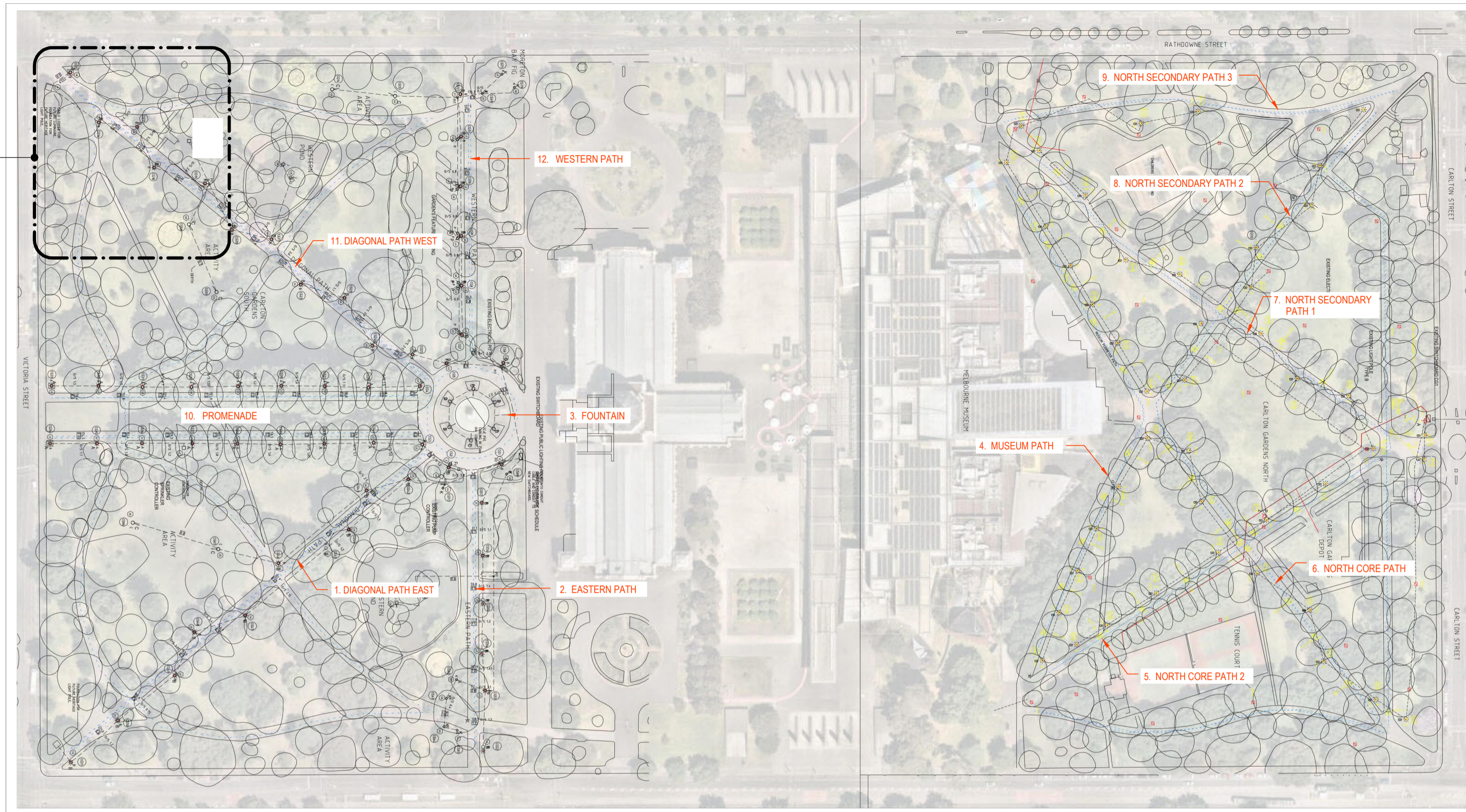

EXISTING PATHWAY ILLUMINATION RESULTS
N.T.S.

P3	17.10.2023	PRELIMINARY ISSUE UPDATE	LZ
P2	08.09.2023	PRELIMINARY ISSUE UPDATE	LZ
P1	24.05.2023	PRELIMINARY ISSUE	LZ
No.	DATE	AMENDMENTS	AUT

Luminaire Schedule						
Symbol	Qty	Type	LLF	Description	Arm	Mounting Height
	99	60W	0.800	Park Light 60W	0	62.8

Calculation Summary				
Label	Avg	Max	Min	Max/Avg
1 Diagonal Path EpH PP2	3.41	10.9	0.2	3.20
1 Diagonal Path EpV PP2	N.A.	7.3	0.1	N.A.
2 Eastern Path EpH PP2	2.99	10.4	0.3	3.48
2 Eastern Path EpV PP2	N.A.	10.5	0.1	N.A.
3 Fountain EpH PP2	1.81	7.7	0.1	4.25
3 Fountain EpV PP2	N.A.	3.6	0.1	N.A.
4 Museum Path EpH PP2	3.25	10.9	0.1	3.35
4 Museum Path EpV PP2	N.A.	7.5	0.1	N.A.
5 North Core Path 2 EpH PP2	2.68	10.6	0.1	3.96
5 North Core Path 2 EpV PP2	N.A.	5.3	0.0	N.A.
6 North Core Path EpH PP2	2.86	10.8	0.2	3.78
6 North Core Path EpV PP2	N.A.	7.4	0.1	N.A.
7 North Secondary Path 1 EpH PP4	0.11	1.6	0.0	14.55
7 North Secondary Path 1 EpV PP4	N.A.	0.4	0.0	N.A.
8 North Secondary Path 2 EpH PP4	0.81	12.1	0.0	14.94
8 North Secondary Path 2 EpV PP4	N.A.	2.2	0.0	N.A.
9 North Secondary Path 3 EpH PP4	1.26	10.4	0.0	8.25
9 North Secondary Path 3 EpV PP4	N.A.	5.5	0.0	N.A.
10 Promenade EpH PP2	3.36	10.8	0.6	3.21
10 Promenade EpV PP2	N.A.	7.1	0.2	N.A.
11 Secondary Path EpH PP4	0.49	9.0	0.0	18.37
11 Secondary Path EpV PP4	N.A.	6.9	0.0	N.A.
12 Western Path EpH PP2	3.30	10.4	0.2	3.15
12 Western Path EpV PP2	N.A.	4.4	0.2	N.A.

LIGHTING CALCULATIONS ARE NOT COMPLYING WITH AS1158.3.1 TABLE 3.4 - VALUES OF LIGHT TECHNICAL PARAMETERS FOR PATHWAYS

LIGHTING SUBCATEGORY: PP4
Average Horizontal Eh = 1.5lx
Point Horizontal Eh = 0.25lx
Point Vertical Epv = 0.05lx
UNIFORMITY =5

LIGHTING CALCULATIONS ARE NOT COMPLYING WITH AS1158.3.1 TABLE 3.4 - VALUES OF LIGHT TECHNICAL PARAMETERS FOR PATHWAYS

LIGHTING SUBCATEGORY: PP2
Average Horizontal Eh = 7lx
Point Horizontal Eh = 1lx
Point Vertical Epv = 0.3lx
UNIFORMITY =5

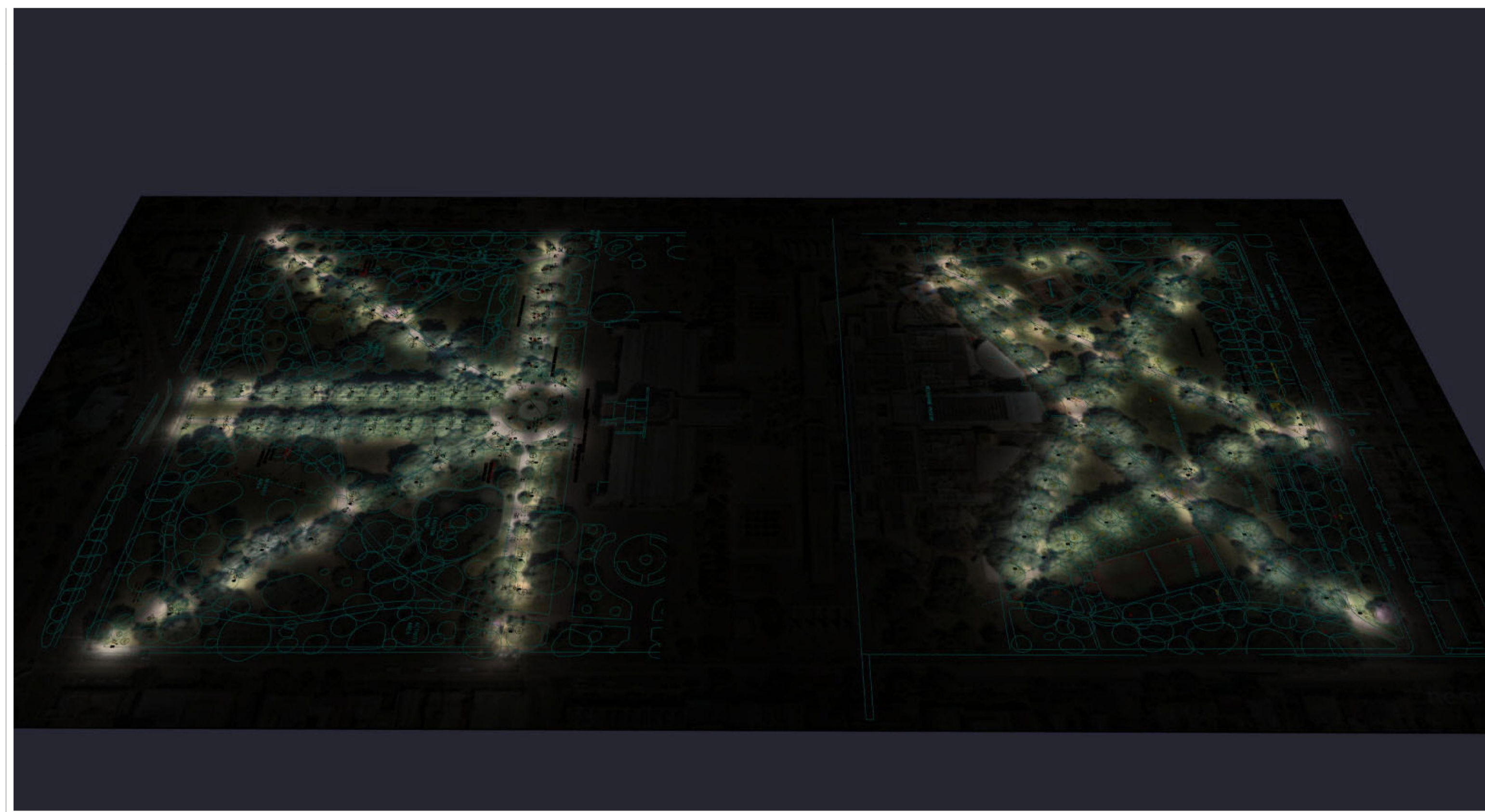

EXISTING PATHWAY NIGHT RENDERING
N.T.S.

CONSULTANT'S DRAWING APPROVAL	
PASSED	APPROVED
LZ	NW

CITY OF MELBOURNE
CITY DESIGN
LEVEL 6 / 240 LT COLLINS STREET
MELBOURNE VIC 3000
TELEPHONE: (03) 9558 8893
FACSIMILE: (03) 9558 8840

HR Consulting Engineers
SUITE 32-33, 150 ALBERT ROAD, SOUTH MELBOURNE, VICTORIA 3205
TEL: (03) 9673 9800 FAX: (03) 9699 8498 EMAIL: info@hrce.com.au

CLIENT
CITY OF MELBOURNE

PROJECT
CARLTON GARDENS
- PROPOSED PUBLIC LIGHTING UPGRADES
1-11 CARLTON ST, CARLTON VIC 3053

DRAWING
EXISTING PATHWAY
PHOTOMETRIC PLOT / RENDERING

STATUS
PRELIMINARY ISSUE

PASSED / REVIEWED	APPROVED / AUTH. FOR USE
-------------------	--------------------------

NORTH POINT 	DESIGN NW	DRAWN LZ
	A1 NTS	A3 NTS
DATE PLOTTED 24.05.2023		

PROJ. NO.	DWG. NO.	REV.
	4081-E7	P3